



Deni Associates  
FORT MYERS, FLORIDA

LEE COUNTY, FLORIDA  
AERIAL MAPPING PROJECT

MAPPING BY:  
WOOLPERT CONSULTANTS

DESIGNATION TBM 17-56 COUNTY LEE STATE FL  
LOCATED IN SEC 16 TWP 44S RGE 26E USGS QUAD MAP OLGA  
TO REACH SURVEY MARK FROM INT. OF ORANGE RIVER BLVD. & BUCKINGHAM RD.:  
GO SOUTH & EAST 1.70 MI ± TO INT.; THENCE EAST & S'LY  
ALONG ORANGE RIVER RD., 0.60 MI ± TO MARK

TYPE OF 8" SPIKE ON N.E. FACE OF POWER POLE (TAG NO. 5 6810 198 307)  
MARK \_\_\_\_\_ DATE SET DEC. 1988  
HORIZONTAL CONTROL ORIGINATED ON 2ND ORDER CONTROL BY N.G.S. AND F.D.O.T.  
ON NORTH AMERICAN DATUM OF 1927 (1927 ADJ) ON NORTH AMERICAN DATUM OF 1983  
COORDINATES (FT) COORDINATES (FT)  
NORTHING (Y) \_\_\_\_\_ NORTHING (Y) \_\_\_\_\_  
EASTING (X) \_\_\_\_\_ EASTING (X) \_\_\_\_\_  
3RD ORDER COORDINATES STATE AND ZONE FLORIDA, MERCATOR WEST

FIELD BOOK \_\_\_\_\_ PAGE \_\_\_\_\_ SKETCH BY WGH

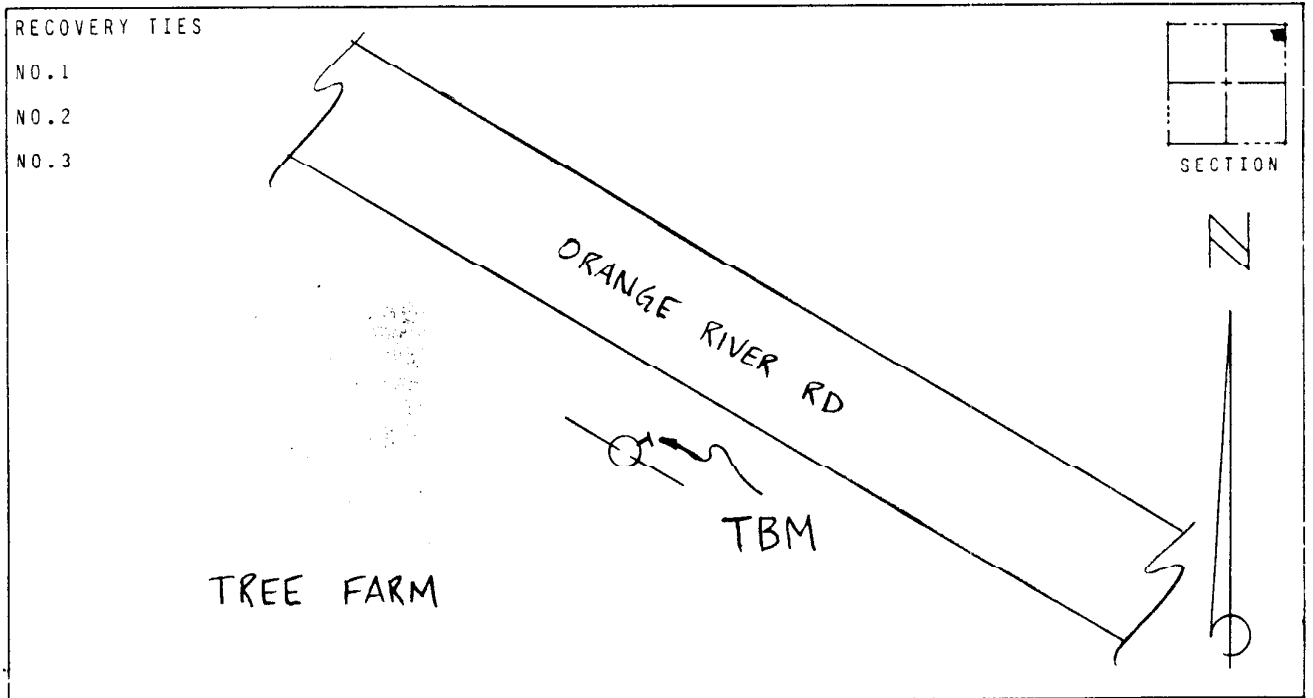

VERTICAL CONTROL ORIGINATED ON 2ND ORDER CONTROL ESTABLISHED BY N.G.S. AND F.D.O.T.  
ON NATIONAL GEODETIC VERTICAL DATUM OF 1929  
ELEVATION (FT) 16.33, 3RD ORDER LEVEL BOOK V 19 PAGE 56