



Deni Associates  
FORT MYERS, FLORIDA

LEE COUNTY, FLORIDA  
AERIAL MAPPING PROJECT

MAPPING BY:  
WOOLPERT CONSULTANTS

DESIGNATION TBM 19-1 COUNTY LEE STATE FL  
LOCATED IN SEC 13 TWP 4 S. RGE 26 E. USGS QUAD MAP OLGA  
TO REACH SURVEY MARK FROM AT INTERSECTION AS SHOWN,  
IN LEHIGH ACRES

TYPE OF 3" BRIDGE SPIKE AND TIN - FLUSH WITH PAVEMENT

MARK \_\_\_\_\_ DATE SET SEPT. 1988

HORIZONTAL CONTROL ORIGINATED ON 2ND ORDER CONTROL BY N.G.S. AND F.D.O.T.

ON NORTH AMERICAN DATUM OF 1927 (1927 ADJ) ON NORTH AMERICAN DATUM OF 1983

COORDINATES (FT) COORDINATES (FT)

NORTHING (Y) \_\_\_\_\_ NORTHING (Y) \_\_\_\_\_

EASTING (X) \_\_\_\_\_ EASTING (X) \_\_\_\_\_

3RD ORDER COORDINATES STATE AND ZONE FLORIDA, MERCATOR WEST

FIELD BOOK \_\_\_\_\_ PAGE \_\_\_\_\_ SKETCH BY WGH

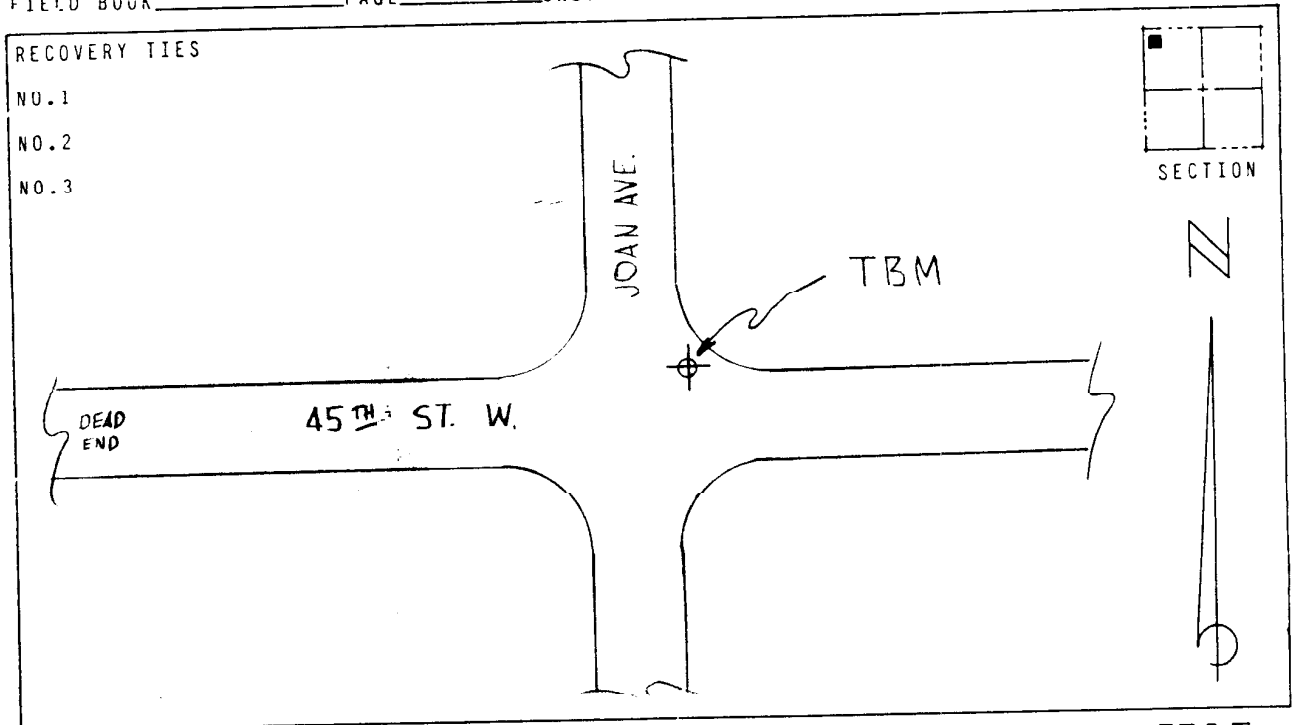

VERTICAL CONTROL ORIGINATED ON 2ND ORDER CONTROL ESTABLISHED BY N.G.S. AND F.D.O.T.  
ON NATIONAL GEODETIC VERTICAL DATUM OF 1929

ELEVATION (FT) 19.68 . 3RD ORDER LEVEL BOOK V 19 PAGE 1