



Deni Associates
FORT MYERS, FLORIDA

LEE COUNTY, FLORIDA
AERIAL MAPPING PROJECT

MAPPING BY:
WOOLPERT CONSULTANTS

DESIGNATION TBM 18-68 COUNTY LEE STATE FL
LOCATED IN SEC 23 13 TWP 14 S RGE 26 E USGS QUAD MAP OLGA
TO REACH SURVEY MARK FROM SUNSHINE BLVD & JOAN AV. GO
WEST ON SUNSHINE FOR 0.15 MILES; THENCE
SOUTHERLY ALONG THE EAST SIDE OF CANAL DITCH
ABOUT 300'± TO SECTION CORNER.

TYPE OF CONC MON / SEC. COR.
MARK _____ DATE SET DEC. 19 88
HORIZONTAL CONTROL ORIGINATED ON 2ND ORDER CONTROL BY N.G.S. AND F.D.O.T.
ON NORTH AMERICAN DATUM OF 1927 (1927 ADJ) ON NORTH AMERICAN DATUM OF 1983
COORDINATES (FT) COORDINATES (FT)
NORTHING (Y) _____ NORTHING (Y) _____
EASTING (X) _____ EASTING (X) _____
3RD ORDER COORDINATES STATE AND ZONE FLORIDA, MERCATOR WEST

FIELD BOOK _____ PAGE _____ SKETCH BY DSW

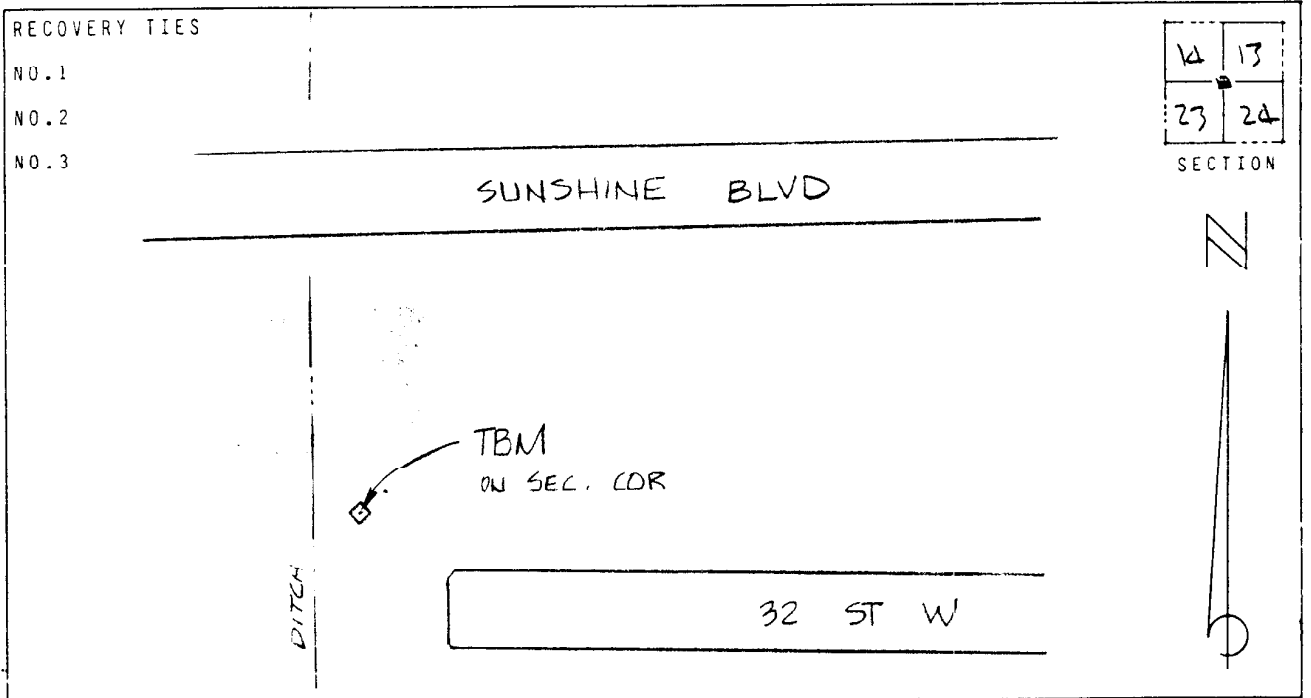

VERTICAL CONTROL ORIGINATED ON 2ND ORDER CONTROL ESTABLISHED BY N.G.S. AND F.D.O.T.
ON NATIONAL GEODETIC VERTICAL DATUM OF 1929
ELEVATION (FT) 20.46 , 3RD ORDER LEVEL BOOK V 18 PAGE 63