



Deni Associates
FORT MYERS, FLORIDA

LEE COUNTY, FLORIDA
AERIAL MAPPING PROJECT

MAPPING BY:
WOOLPERT CONSULTANTS

DESIGNATION TBM 19-23 COUNTY LEE STATE FL
 LOCATED IN SEC 35 TWP 44S RGE 26E USGS QUAD MAP OLGA
 TO REACH SURVEY MARK FROM HICKEY CREEK RD. & C.R. 80; THENCE S.
0.75 MI. TO INT.; THENCE S. ON PRIVATE ROAD
0.25 MI TO GATE @ NE COR SEC. 35; THENCE S &
THROUGH PASTURES TO SW COR SEC 35 & MARK,

TYPE OF 5 BRIDGE SPIKE IN LARGE WOOD FENCE POST

MARK _____ DATE SET SEPT. 1988

HORIZONTAL CONTROL ORIGINATED ON 2ND ORDER CONTROL BY N.G.S. AND F.D.O.T.

ON NORTH AMERICAN DATUM OF 1927 (1927 ADJ) ON NORTH AMERICAN DATUM OF 1983

COORDINATES (FT) COORDINATES (FT)

NORTHING (Y) _____ NORTHING (Y) _____

EASTING (X) _____ EASTING (X) _____

3RD ORDER COORDINATES STATE AND ZONE FLORIDA, MERCATOR WEST

FIELD BOOK _____ PAGE _____ SKETCH BY DSW

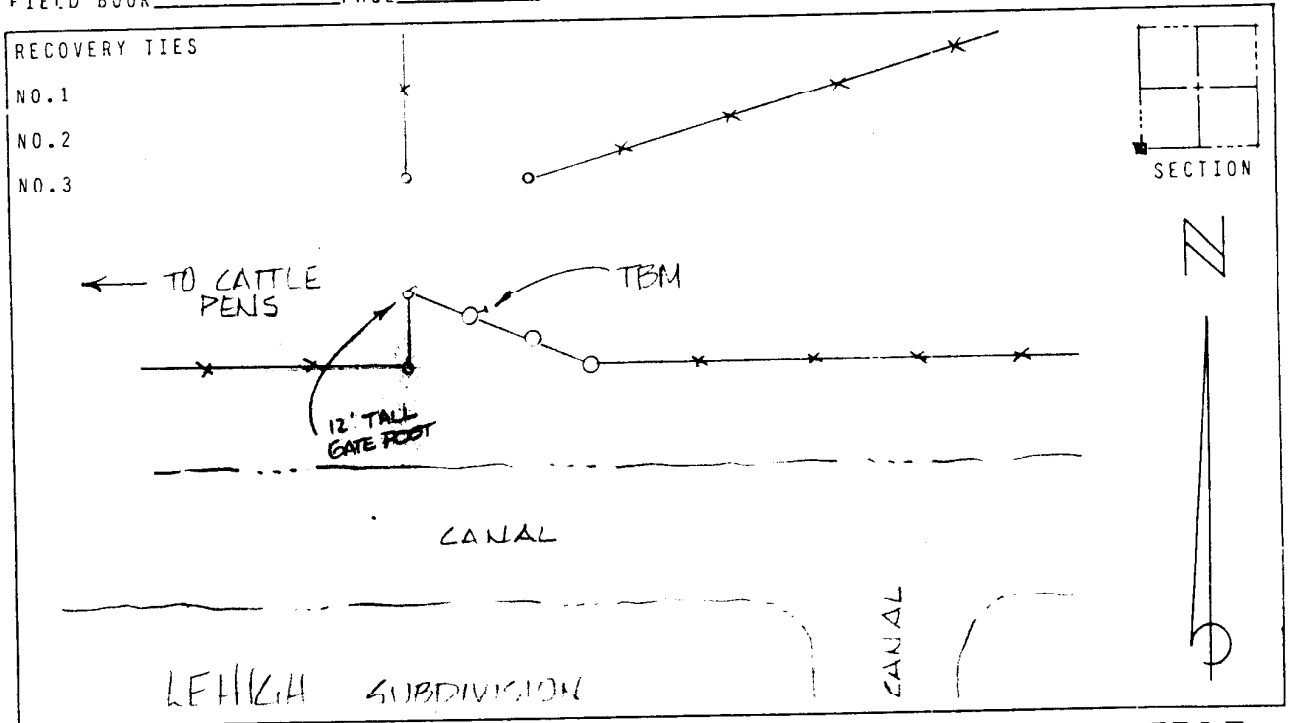

VERTICAL CONTROL ORIGINATED ON 2ND ORDER CONTROL ESTABLISHED BY N.G.S. AND F.D.O.T.

ON NATIONAL GEODETIC VERTICAL DATUM OF 1929

ELEVATION (FT) 17.97 , 3RD ORDER LEVEL BOOK V 19 PAGE 23