



Deni Associates
FORT MYERS, FLORIDA

LEE COUNTY, FLORIDA
AERIAL MAPPING PROJECT

MAPPING BY:
WOOLPERT CONSULTANTS

DESIGNATION TBM 18-54 COUNTY LEE STATE FL
 LOCATED IN SEC 28 TWP 44S RGE 26E USGS QUAD MAP ALVA SIX
 TO REACH SURVEY MARK FROM LEE BLVD & GUNNERY ROAD; GO EAST
ON LEE BLVD 0.15 MILES TO ADDRESS #4303 LEE BLVD.

TYPE OF MARK AT NE COR OF CONC. DRIVE
 MARK E R/W LINE DATE SET DEC. 19 88
 HORIZONTAL CONTROL ORIGINATED ON 2ND ORDER CONTROL BY N.G.S. AND F.D.O.T.
 ON NORTH AMERICAN DATUM OF 1927 (1927 ADJ) ON NORTH AMERICAN DATUM OF 1983
 COORDINATES (FT) COORDINATES (FT)
 NORTHING (Y) _____ NORTHING (Y) _____
 EASTING (X) _____ EASTING (X) _____
3RD ORDER COORDINATES STATE AND ZONE FLORIDA, MERCATOR WEST

FIELD BOOK _____ PAGE _____ SKETCH BY DSW

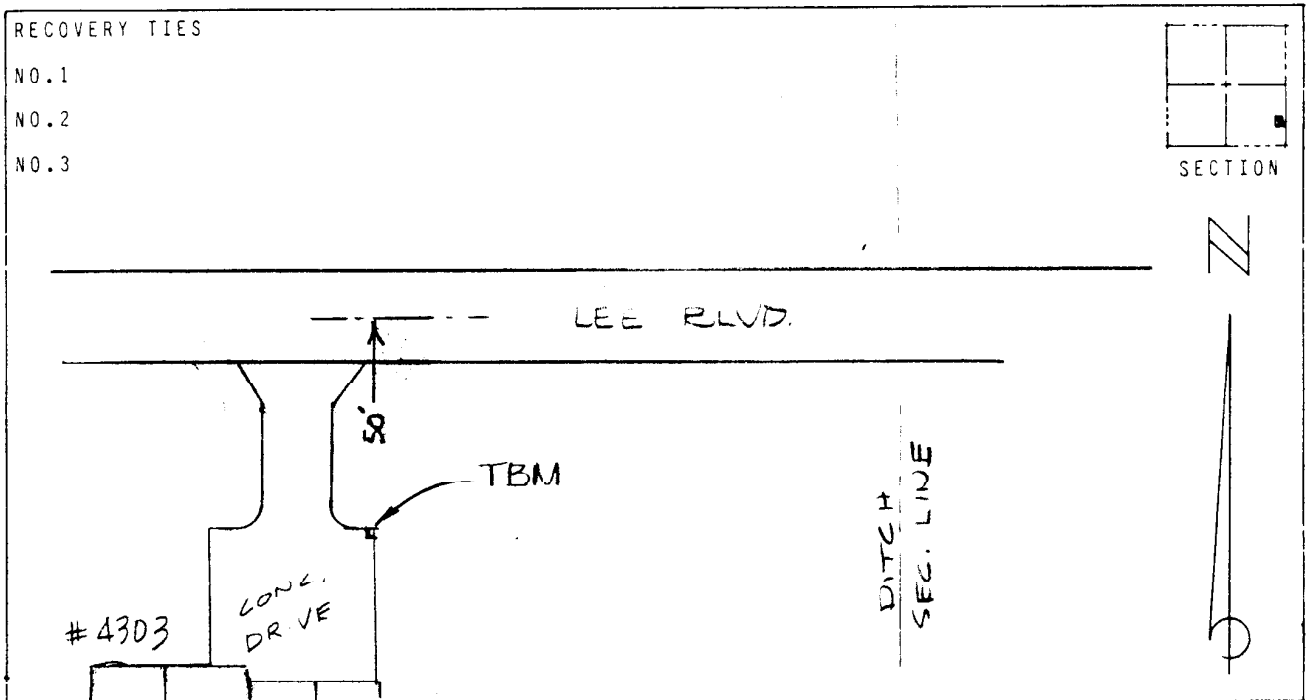

VERTICAL CONTROL ORIGINATED ON 2ND ORDER CONTROL ESTABLISHED BY N.G.S. AND F.D.O.T.
 ON NATIONAL GEODETIC VERTICAL DATUM OF 1929
 ELEVATION (FT) 25.50 , 3RD ORDER LEVEL BOOK 18 PAGE 54