



Deni Associates  
FORT MYERS, FLORIDA

LEE COUNTY, FLORIDA  
AERIAL MAPPING PROJECT  
MAPPING BY:  
WOOLPERT CONSULTANTS

DESIGNATION TBM 18.1 COUNTY LEE STATE FL  
LOCATED IN SEC 4 TWP 45 RGE 26E USGS QUAD MAP OLGA  
TO REACH SURVEY MARK FROM BLICKINGHAM ROAD & CEMETERY ROAD  
GO 0.6 MILES TO SAND ROAD NORTH & MARK.

TYPE OF CHISELED □ ON EAST END RCP CULVERT.  
MARK \_\_\_\_\_ DATE SET JULY 1988  
HORIZONTAL CONTROL ORIGINATED ON 2ND ORDER CONTROL BY N.G.S. AND F.D.O.T.  
ON NORTH AMERICAN DATUM OF 1927 (1927 ADJ) ON NORTH AMERICAN DATUM OF 1983  
COORDINATES (FT) COORDINATES (FT)  
NORTHING (Y) \_\_\_\_\_ NORTHING (Y) \_\_\_\_\_  
EASTING (X) \_\_\_\_\_ EASTING (X) \_\_\_\_\_  
3RD ORDER COORDINATES STATE AND ZONE FLORIDA, MERCATOR WEST

FIELD BOOK \_\_\_\_\_ PAGE \_\_\_\_\_ SKETCH BY RLW

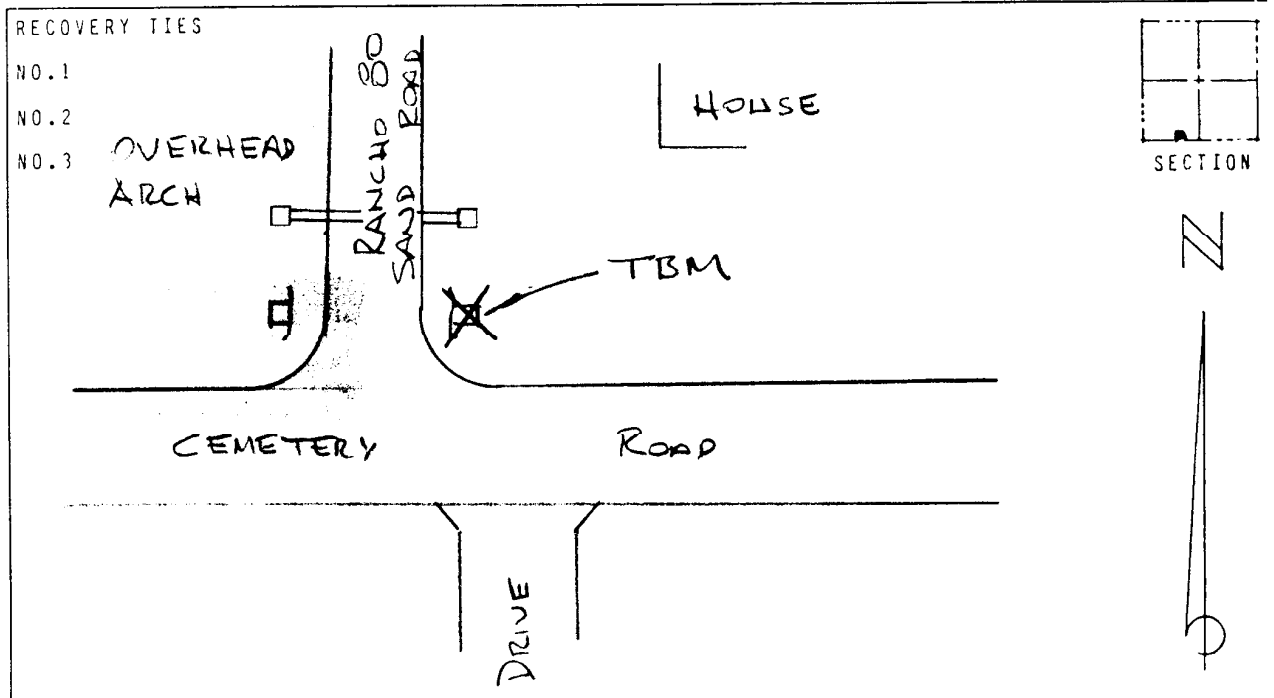

VERTICAL CONTROL ORIGINATED ON 2ND ORDER CONTROL ESTABLISHED BY N.G.S. AND F.D.O.T.  
ON NATIONAL GEODETIC VERTICAL DATUM OF 1929  
ELEVATION FT 11.66 3RD ORDER LEVEL BOOK V 18 PAGE 1