



# Deni Associates

7025 N.W. 4th St. - Plantation, Florida 33317

## LEE COUNTY, FLORIDA AERIAL MAPPING PROJECT

MAPPING BY  
HAMRICK AERIAL SURVEYS, INC.  
CLEARWATER, FLORIDA

Marker Designation TBM SMCV-6 County LEE State FL

Located in Sec. 27 Twp. 44 S Rye. 25 E. U.S.G.S. Quad Map FORT MYERS SE 7.5min.

To reach point from INT S.R. 82 & 1-79 (S.): GO S. 0.9 MI. ±  
TO POINT.

Type of Marker CHISELED "□" IN CONC. HEADWALL Date set JUNE 19 80

HORIZONTAL CONTROL originated on 2nd order control established by FLA. D.O.T.

in 1972, on North American 1927 datum. agency

Coordinates: North (y) \_\_\_\_\_ East (x) \_\_\_\_\_  
(feet)

3rd Order State and Zone Florida, Mercator West

Reference Bearings to Station or Object:

Description	Bearing	Distance

Field Book \_\_\_\_\_ Page \_\_\_\_\_ Sketch by M.M. HOMOLA

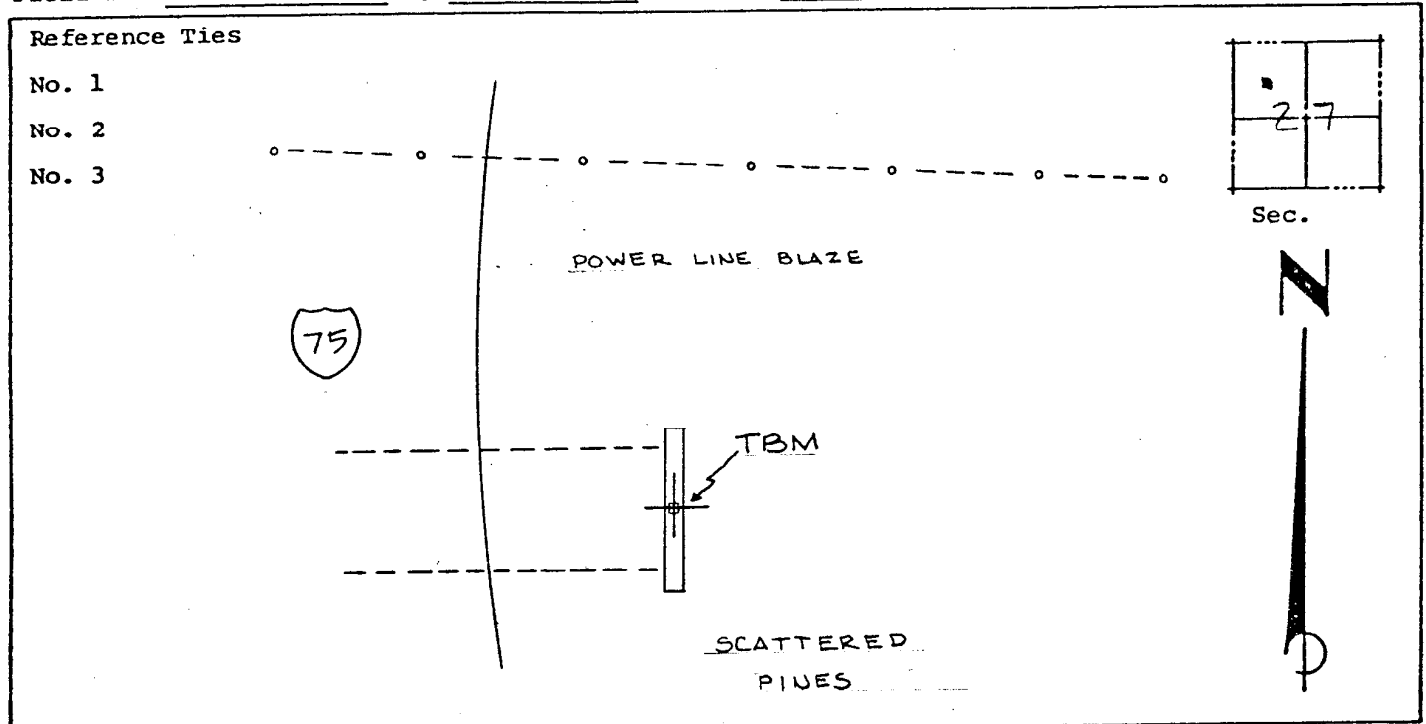

VERTICAL CONTROL originated on 3<sup>RD</sup> order control established by USGS

in 1971, on National Geodetic Survey Datum of 1929 datum. agency

year  
Elevation 21.79, 3rd Order Level Book V3 Page 2  
(feet)