



# Deni Associates

7025 N.W. 4th St. · Plantation, Florida 33317

## LEE COUNTY, FLORIDA AERIAL MAPPING PROJECT

MAPPING BY  
HAMRICK AERIAL SURVEYS, INC.  
CLEARWATER, FLORIDA

Marker Designation TBM SMCV-7 County LEE State FL  
Located in Sec. 34 Twp. 44S Rge. 25 E. U.S.C.S. Quad Map FORT MYERS SE 7.5min.  
To reach point from INT. S.R. 82 & 1-75 (S): GO S. 2.3 MI. I TO  
POINT

Type of Marker STD. FLA. D.O.T. DISC Date set JUNE 19 80  
HORIZONTAL CONTROL originated on 2nd order control established by FLA. D.O.T.  
in 1972, on North American 1927 datum. agency  
Coordinates: North (y) \_\_\_\_\_ East (x) \_\_\_\_\_  
(feet) 3rd Order State and Zone Florida, Mercator West

Reference Bearings to Station or Object:

Description	Bearing	Distance

Field Book \_\_\_\_\_ Page \_\_\_\_\_ Sketch by M.M. HOMOLA

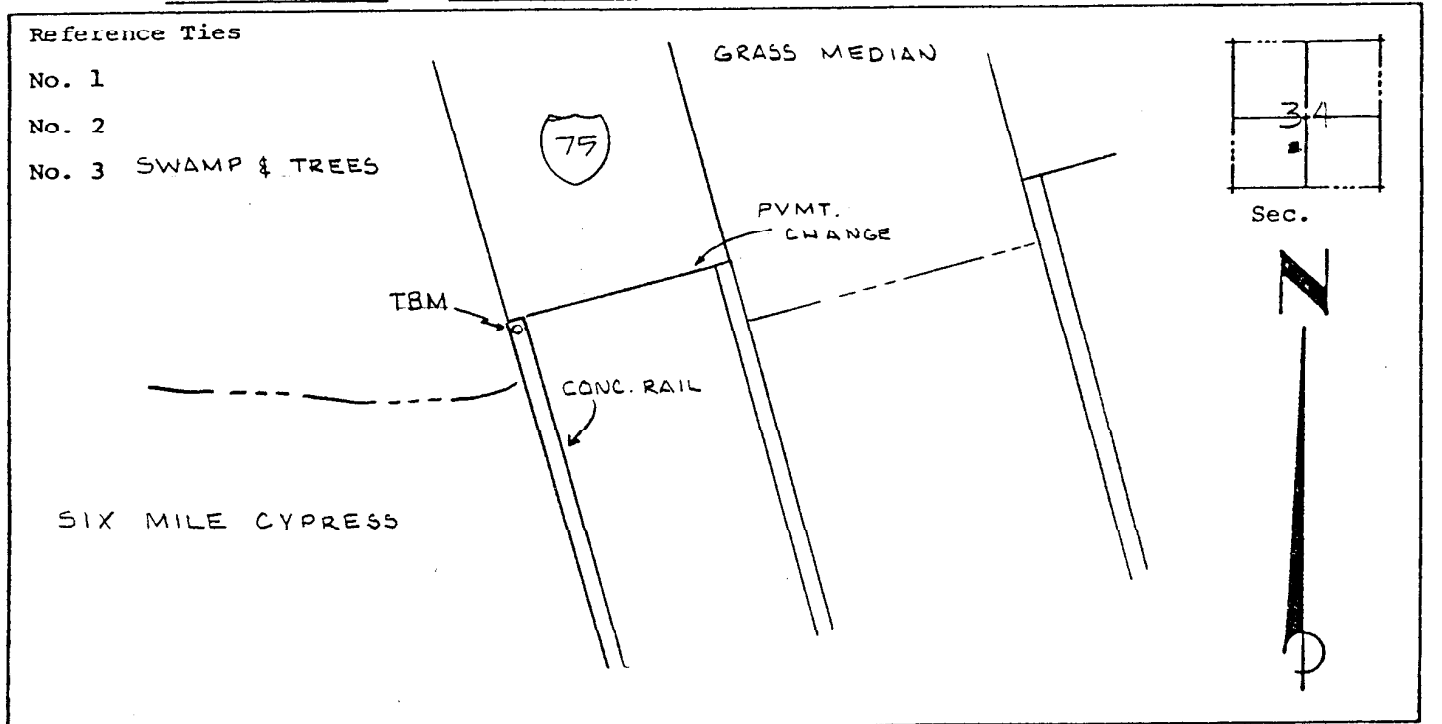

VERTICAL CONTROL originated on 3<sup>rd</sup> order control established by USGS  
in 1971, on National Geodetic Survey Datum of 1929 datum. agency  
Elevation 26.65, 3rd Order Level Book V3 Page 3  
(feet)