



Deni Associates
 RT. 3, 11555 MARSHWOOD LN. S.W.
 FORT MYERS, FL 33908

LEE COUNTY, FLORIDA
 AERIAL MAPPING PROJECT

MAPPING BY
 HAMRICK AERIAL SURVEYS, INC.
 CLEARWATER, FLORIDA

DESIGNATION TBM SFMV-11 COUNTY LEE STATE FL
 LOCATED IN SEC. 31 TWP 44 S. RGC 24 E. USGS QUAD MAP FORT MYERS SW

TO REACH SURVEY MARK FROM INT. COLONIAL BLVD. / SR 884 & MCGREGOR BLVD. / SR 36
GO N. 0.2 MI ± TO SAN JUAN AVE. & MARK.

TYPE OF MARK WHEELED "X" ON MANHOLE RIM DATE SET FEBRUARY 1982

HORIZONTAL CONTROL ORIGINATED ON _____ ORDER CONTROL ESTABLISHED BY _____
 IN _____, ON _____

COORDINATES (FT) NORTH (Y) _____ EAST (X) _____
 _____ ORDER STATE AND ZONE _____

REFERENCE BEARINGS TO STATION OR OBJECT

DESCRIPTION	BEARING	DISTANCE
_____	_____	_____
_____	_____	_____
_____	_____	_____

FIELD BOOK _____ PAGE _____ SKETCH BY DW ALBERTSEN

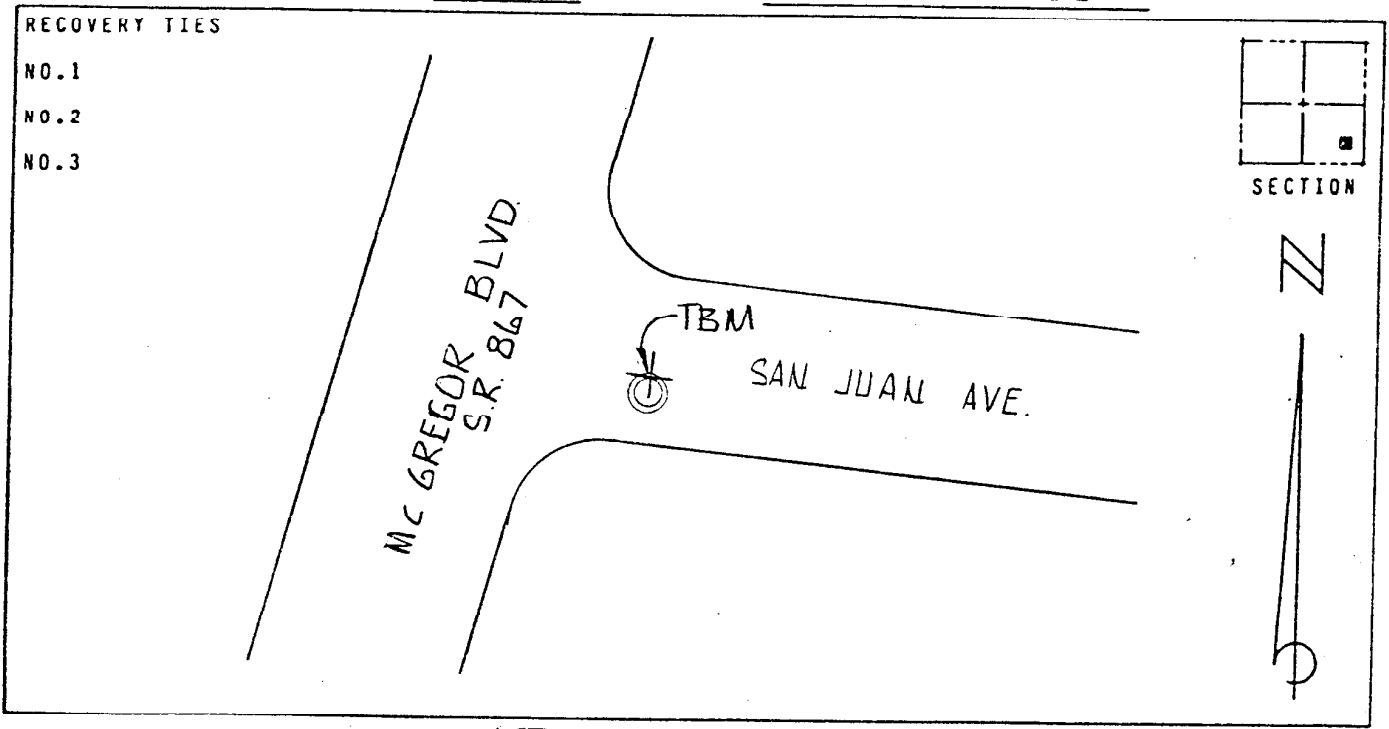

VERTICAL CONTROL ORIGINATED ON 1ST ORDER CONTROL ESTABLISHED BY USC & GS
 IN 1966, ON NATIONAL GEODETIC VERTICAL DATUM 1929.
 ELEVATION (FT) 12.61, 3RD ORDER LEVEL BOOK V6 PAGE 47