



Dani Associates

RT. 3, 11555 MARSHWOOD LN. S.W.
FORT MYERS, FL 33908

LEE COUNTY, FLORIDA
AERIAL MAPPING PROJECT

MAPPING BY
HAMRICK AERIAL SURVEYS, INC.
CLEARWATER, FLORIDA

DESIGNATION TBM NFMV-2 COUNTY LEE STATE FLA

LOCATED IN SEC 15 TWP 44S RGE 24E USGS QUAD MAP FT. MYERS NW

TO REACH SURVEY MARK FROM INT. OF U.S. 41 AND SR 78A; GO 0.6 MI±
TO MOODY RD; THENCE S 1.25 MI± TO WOLCOTT DR AND TBM

TYPE OF MARK 8" SPK IN E. FACE OF GUY POLE DATE SET DEC. 19 81

HORIZONTAL CONTROL ORIGINATED ON _____ ORDER CONTROL ESTABLISHED BY _____
IN _____, ON _____.

COORDINATES (FT) NORTH (Y) _____ EAST (X) _____
_____ ORDER STATE AND ZONE _____

REFERENCE BEARINGS TO STATION OR OBJECT

DESCRIPTION	BEARING	DISTANCE
_____	_____	_____
_____	_____	_____
_____	_____	_____

FIELD BOOK _____ PAGE _____ SKETCH BY ACL

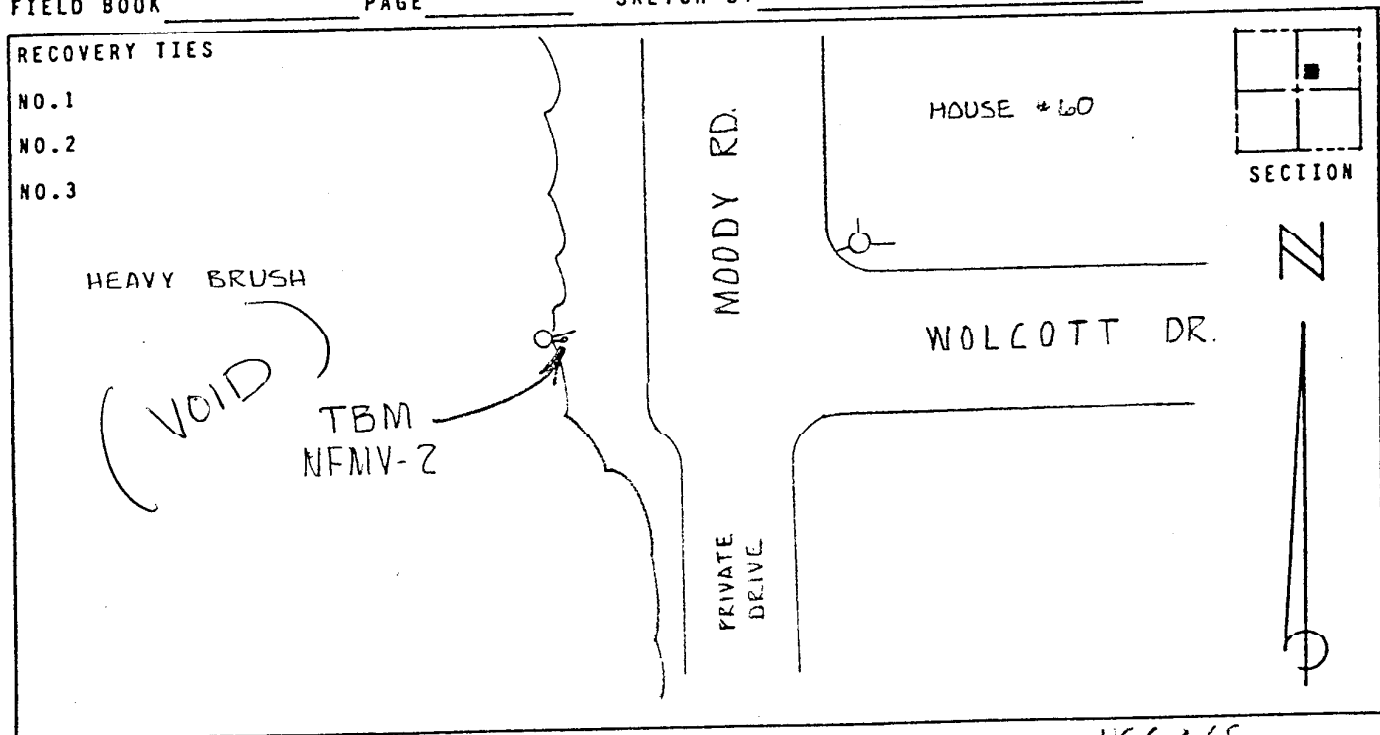

VERTICAL CONTROL ORIGINATED ON 1ST ORDER CONTROL ESTABLISHED BY USC & GS
IN 1965, ON NATIONAL GEODETIC SURVEY DATUM OF 1929

ELEVATION (FT) 02.98, 3RD ORDER LEVEL BOOK Y6 PAGE 10