



Deni Associates

7025 N.W. 4th St. - Plantation, Florida 33317

LEE COUNTY, FLORIDA AERIAL MAPPING PROJECT

MAPPING BY
HAMRICK AERIAL SURVEYS, INC.
CLEARWATER, FLORIDA

Marker Designation TBM PISV-9 County LEE State FL

Located in Sec. 32 Twp. 44S Rge. 22E U.S.G.S. Quad Map CAPTIVA 7.5min.

To reach point from INT. OF SR. 78 & 767 IN PINE ISLAND CENTER. GO S. ON
SR. 767 1.5 MI.± TO MARIA RD.; THENCE W. 1.2 MI.± TO FISHERY BLDG.
& MARKER.

Type of Marker CHISELED "I" ON TOP OF CONC. SEAWALL Date set MARCH 19 81

HORIZONTAL CONTROL originated on _____ order control established by _____

in _____, on _____ North American 1927 _____ datum. _____ agency

Coordinates: North (y) _____ East (x) _____
(feet)

3rd Order State and Zone Florida, Mercator West

Reference Bearings to Station or Object:

Description	Bearing	Distance

Field Book _____ Page _____ Sketch by B.R. HOMOLA

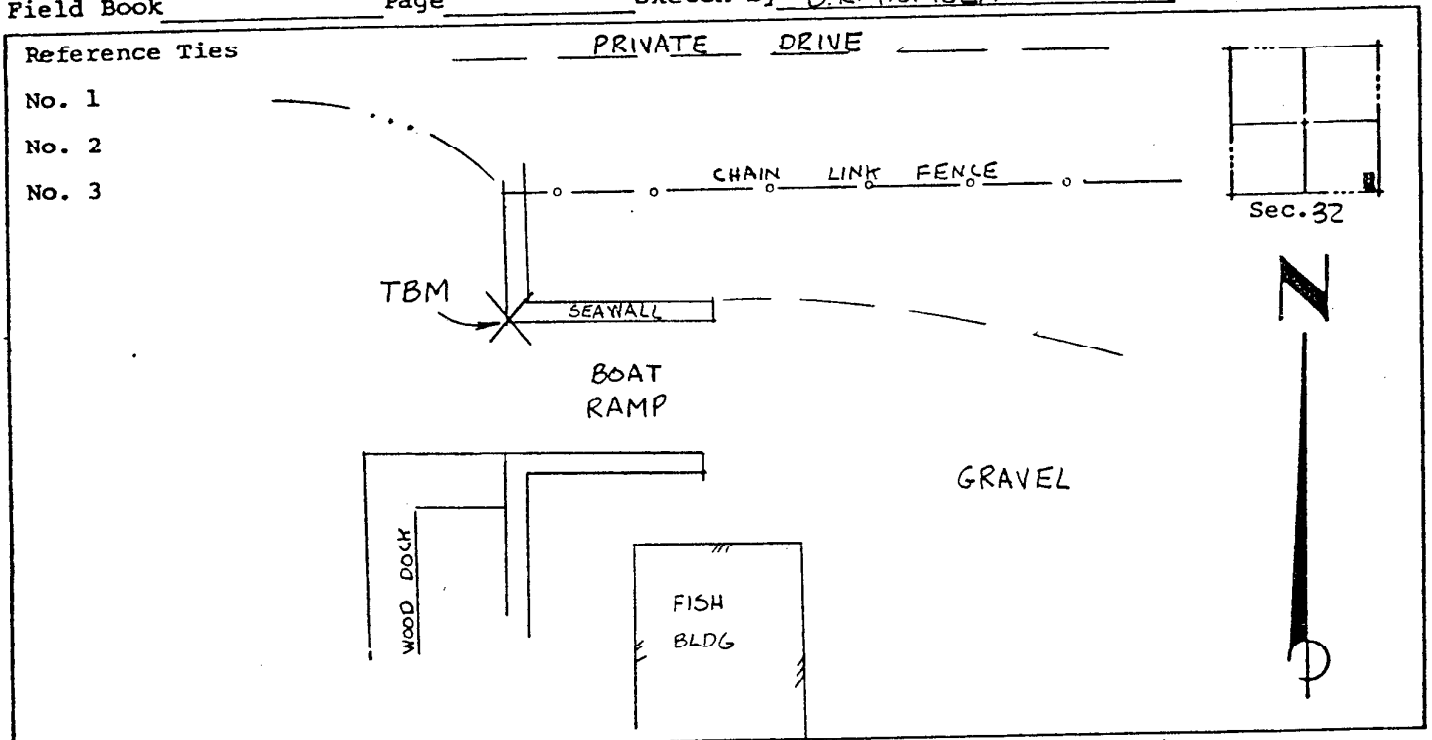

VERTICAL CONTROL originated on 1ST order control established by USC & GS agency

in 1966, on National Geodetic Survey Datum of 1929 datum.

year _____
Elevation 3.63, 3rd Order Level Book V4 Page 4
(feet)