



# Deni Associates

7025 N.W. 4th St. • Plantation, Florida 33317

LEE COUNTY, FLORIDA  
AERIAL MAPPING PROJEC

MAPPING BY  
HAMRICK AERIAL SURVEYS, INC.  
CLEARWATER, FLORIDA

Marker Designation USED BM L7 County LEE State FL

Located in Sec. 28 Twp. 44S Rge. 22E U.S.G.S. Quad Map PINE ISLAND CENTER 7.5min

To reach point from \_\_\_\_\_

@ INT. SR 78 & SR 767 IN PINE ISLAND CENTER

Type of Marker STD BRASS DISC SET IN CONC CULV HDWL Date <sup>RECOVERED</sup> MAY 19 81

HORIZONTAL CONTROL originated on \_\_\_\_\_ order control established by \_\_\_\_\_

in \_\_\_\_\_, on North American 1927 datum. \_\_\_\_\_ agency

Coordinates: North (y) \_\_\_\_\_ East (x) \_\_\_\_\_  
(feet)

3rd Order State and Zone Florida, Mercator West

Reference Bearings to Station or Object:

Description	Bearing	Distance

Field Book \_\_\_\_\_ Page \_\_\_\_\_ Sketch by A. LETHERY

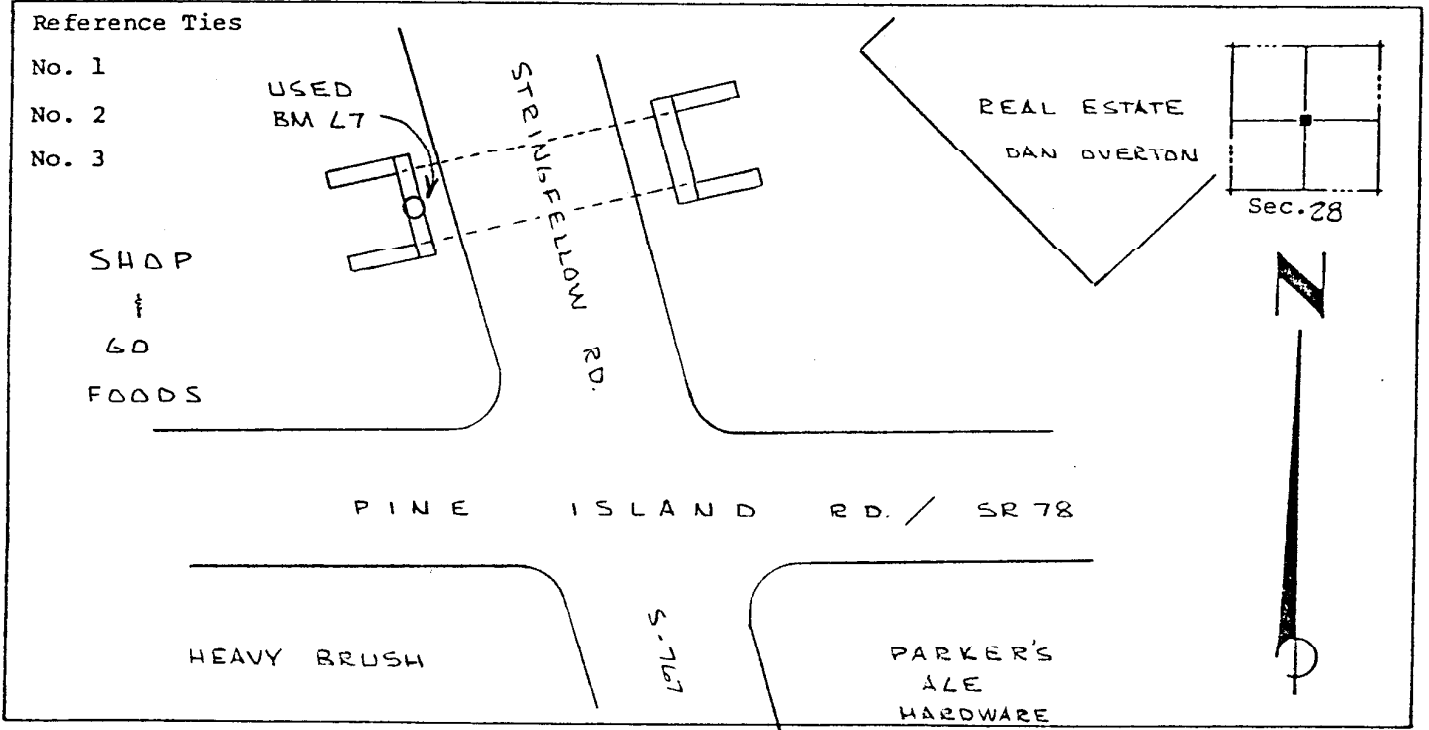

VERTICAL CONTROL originated on 1st order control established by USC & GS agency

in 1966 year, on National Geodetic Survey Datum of 1929 datum.

Elevation 8.556 (feet), 3rd Order Level Book V5 Page 20