



Deni Associates

7025 N.W. 4th St. - Plantation, Florida 33317

LEE COUNTY, FLORIDA AERIAL MAPPING PROJECT

MAPPING BY
HAMRICK AERIAL SURVEYS, INC.
CLEARWATER, FLORIDA

Marker Designation TBM PISV-14 County LEE State FL

Located in Sec. 21 Twp. 44S Rge. 22E U.S.G.S. Quad Map MATLACHA 7.5min.

To reach point from INT. SR 78 & SR 767 IN PINE ISLAND CENTER:

GO N. 1.0 MI ± TO LINDEN LN & MARKER.

Type of Marker CH "E" ON N. END OF CONC. CULV. Date set MAY 19 81

HORIZONTAL CONTROL originated on _____ order control established by _____

in _____, on _____ North American 1927 _____ datum. _____ agency

Coordinates: North (y) _____ East (x) _____
(feet)

3rd Order State and Zone Florida, Mercator West

Reference Bearings to Station or Object:

Description	Bearing	Distance

Field Book _____ Page _____ Sketch by A. LETHBY

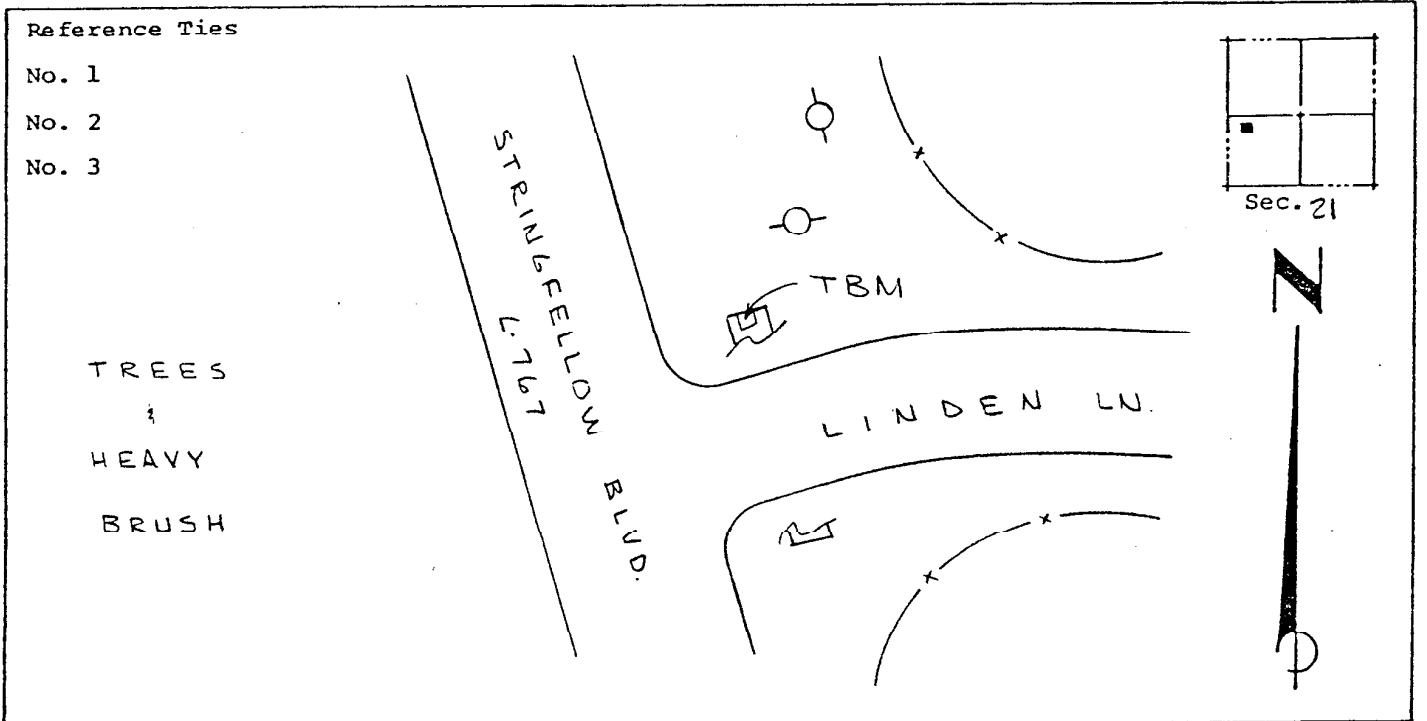

VERTICAL CONTROL originated on 1st order control established by USGS agency

in 1966, on _____ National Geodetic Survey Datum of 1929 _____ datum.

Elevation 06.57, 3rd Order Level Book VS Page 19

(feet)