



Deni Associates
FORT MYERS, FLORIDA

LEE COUNTY, FLORIDA
AERIAL MAPPING PROJECT
MAPPING BY: HAMRICK AERIAL SURVEYS, INC.
CLEARWATER, FLORIDA

DESIGNATION TBM ALVA KM 3 COUNTY LEE STATE FL
LOCATED IN SEC 25 TWP 43 S. RGE 27 E USGS QUAD MAP ALVA 7.5 MIN.

TO REACH SURVEY MARK FROM _____
AT INT. S.R. 80 + COUNTY LINE.

TYPE OF MARK STD USC & GS BRASS CAP IN CONC. DATE ~~SET~~ ^{RECOVERED} MAY 19 85

HORIZONTAL CONTROL ORIGINATED ON _____ ORDER CONTROL ESTABLISHED BY _____
IN _____, ON NORTH AMERICAN DATUM OF 1927.

COORDINATES (FT) NORTH (Y) _____ EAST (X) _____
3RD ORDER STATE AND ZONE FLORIDA, MERCATOR WEST

REFERENCE BEARINGS TO STATION OR OBJECT

DESCRIPTION	BEARING	DISTANCE
_____	_____	_____
_____	_____	_____
_____	_____	_____

FIELD BOOK _____ PAGE _____ SKETCH BY EVS

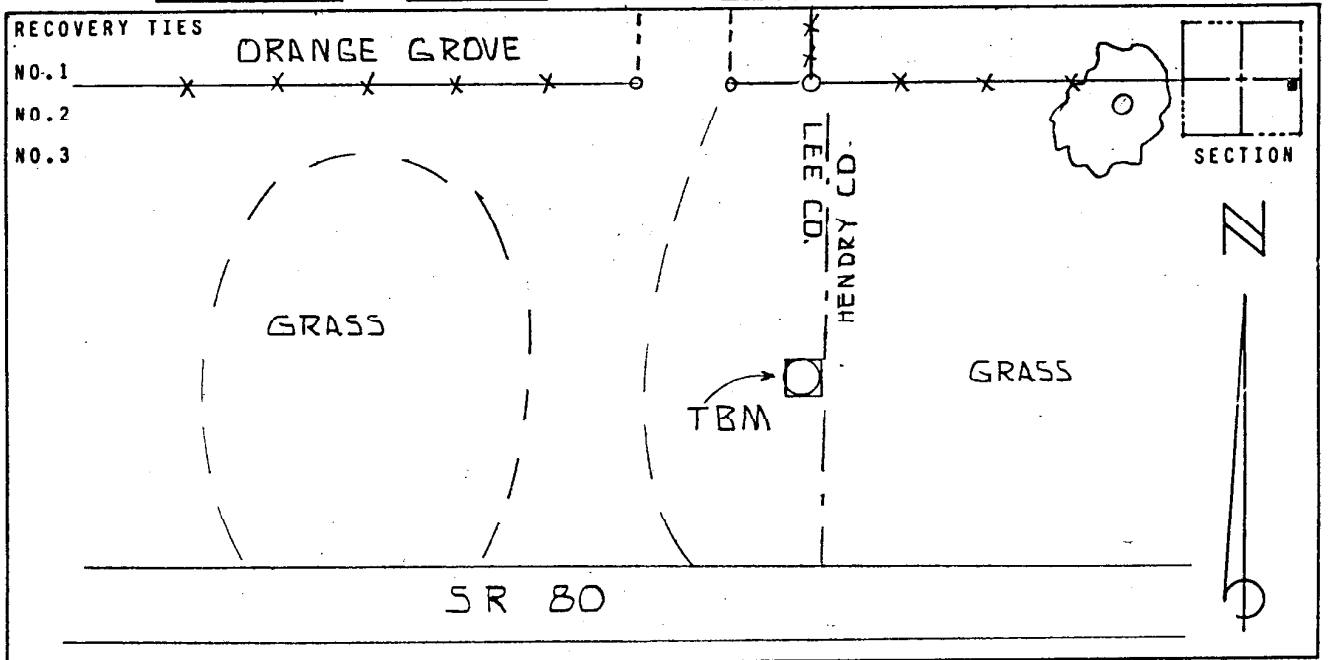

VERTICAL CONTROL ORIGINATED ON 1ST ORDER CONTROL ESTABLISHED BY USC + GS
IN 1966, ON NATIONAL GEODETIC SURVEY DATUM OF 1929.

ELEVATION (FT) 11.05, 3RD ORDER LEVEL BOOK 16 PAGE 14.