



Deni Associates
FORT MYERS, FLORIDA

LEE COUNTY, FLORIDA
AERIAL MAPPING PROJECT
MAPPING BY: HAMRICK AERIAL SURVEYS, INC.
CLEARWATER, FLORIDA

DESIGNATION TBM 17-10 COUNTY LEE STATE FL
LOCATED IN SEC 23 TWP 43 S. RGE 27 E USGS QUAD MAP ALVA 7.5 MIN.

TO REACH SURVEY MARK FROM THE BROADWAY ST. BRIDGE OVER THE
CALOOSAHATCHEE R. IN ALVA: GO N. 0.2 MI.± TO C.R. 78 (CENTER
ST.); THENCE E., THEN N. 0.75 MI.± ON C.R. 78 TO A 90°
BEND TO THE E.; THENCE E. 0.9 MI.± TO MARK.

TYPE OF MARK RR SPIKE IN N. FACE OF PINE DATE SET MAY 19 85

HORIZONTAL CONTROL ORIGINATED ON _____ ORDER CONTROL ESTABLISHED BY _____
IN _____, ON NORTH AMERICAN DATUM OF 1927.

COORDINATES (Ft) NORTH (Y) _____ EAST (X) _____
3RD ORDER STATE AND ZONE FLORIDA, MERCATOR WEST

REFERENCE BEARINGS TO STATION OR OBJECT

DESCRIPTION	BEARING	DISTANCE

FIELD BOOK _____ PAGE _____ SKETCH BY EVS

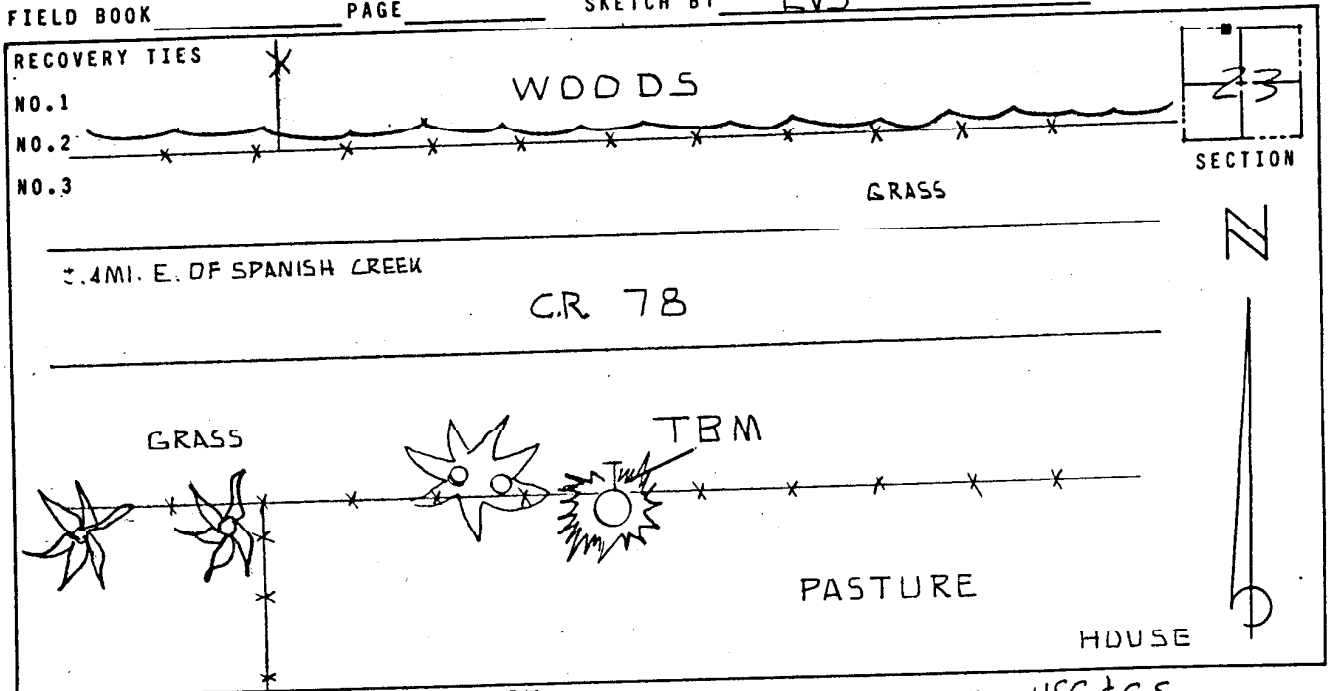

VERTICAL CONTROL ORIGINATED ON 1ST ORDER CONTROL ESTABLISHED BY USC & GS
IN 1966, ON NATIONAL GEODETIC SURVEY DATUM OF 1929.

ELEVATION (FT) 18.15 . 3RD ORDER LEVEL BOOK 17 PAGE 10