



Deni Associates
FORT MYERS, FLORIDA

LEE COUNTY, FLORIDA
AERIAL MAPPING PROJECT
MAPPING BY: HAMRICK AERIAL SURVEYS, INC.
CLEARWATER, FLORIDA

DESIGNATION TBM 17-9 COUNTY LEE STATE FL
LOCATED IN SEC 22 TWP 43 S. RGE 27E USGS QUAD MAP ALVA 7.5 MIN.

TO REACH SURVEY MARK FROM THE BROADWAY ST. BRIDGE OVER THE
CALOOSA HATCHEE R. IN ALVA; GO N. 0.2 MI ± TO C.R. 78 (CENTER
ST.); THENCE E., THEN N. 0.75 MI ± ON C.R. 78 TO MARK.

TYPE OF MARK RR SPIKE IN SEFACE OF PINE DATE SET MAY 19 85

HORIZONTAL CONTROL ORIGINATED ON _____ ORDER CONTROL ESTABLISHED BY _____
IN _____, ON NORTH AMERICAN DATUM OF 1927.

COORDINATES (FT) NORTH (Y) _____ EAST (X) _____
3RD ORDER STATE AND ZONE FLORIDA, MERCATOR WEST

REFERENCE BEARINGS TO STATION OR OBJECT

DESCRIPTION	BEARING	DISTANCE
_____	_____	_____
_____	_____	_____
_____	_____	_____

FIELD BOOK _____ PAGE _____ SKETCH BY EVS

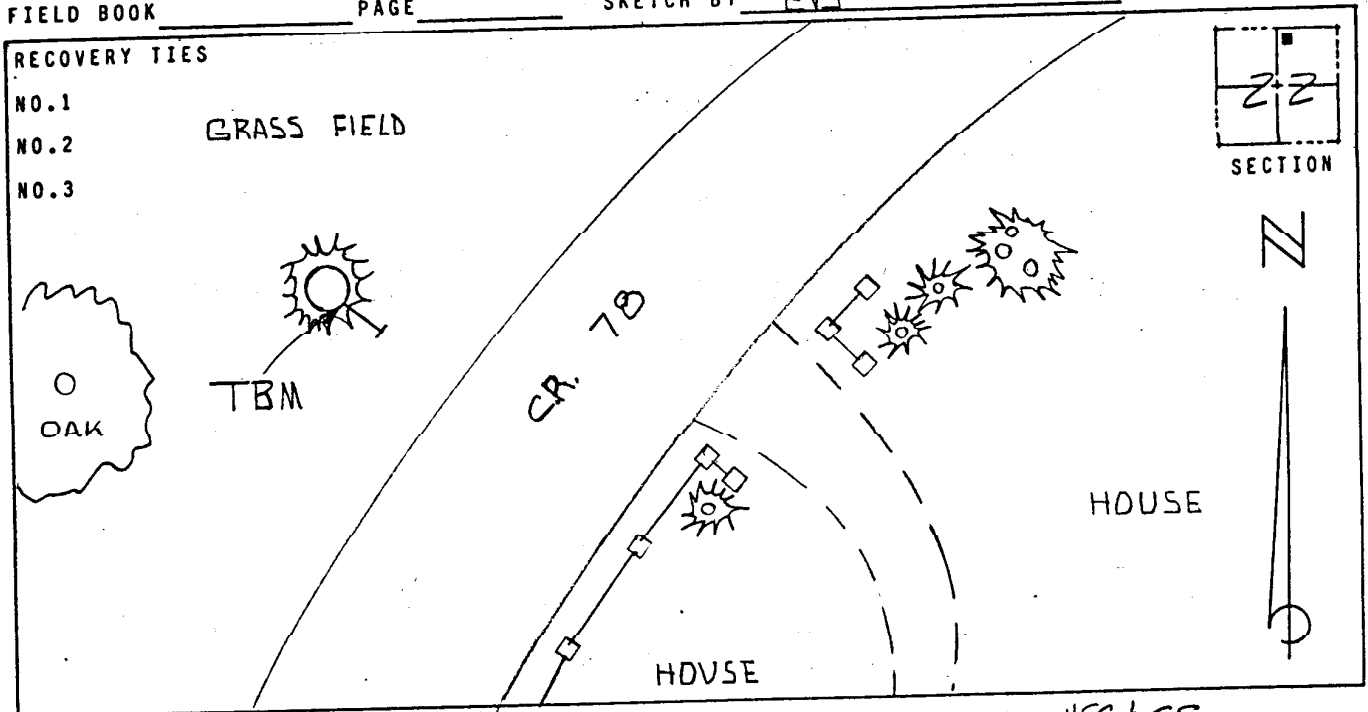

VERTICAL CONTROL ORIGINATED ON 1ST ORDER CONTROL ESTABLISHED BY USC & GS
IN 1966, ON NATIONAL GEODETIC SURVEY DATUM OF 1929.

ELEVATION (FT) 18.05, 3RD ORDER LEVEL BOOK 17 PAGE 9