



Deni Associates
FORT MYERS, FLORIDA

LEE COUNTY, FLORIDA
AERIAL MAPPING PROJECT

MAPPING BY:
WOOLPERT CONSULTANTS

DESIGNATION LH 55 & TRM COUNTY LEE STATE FL
 LOCATED IN SEC 13 TWP 43S RGE 27E USGS QUAD MAP ALVA
 TO REACH SURVEY MARK FROM CR 78 & LEE/HENDRY Co. LINE; THENCE WESTERLY FOR 0.65 TO GROVE ENT; THENCE 0.75 MILES TO T INT; THENCE 0.6 MILES EASTERLY TO MARK.

TYPE OF 2" ALUM. CAP ON RE-BAR
 MARK 2" BLW. GRD. DATE SET JULY 1988
 HORIZONTAL CONTROL ORIGINATED ON 2ND ORDER CONTROL BY N.G.S. AND F.D.O.T.
 ON NORTH AMERICAN DATUM OF 1927 (1927 ADJ) ON NORTH AMERICAN DATUM OF 1983
 COORDINATES (FT) COORDINATES (FT)
 NORTHING (Y) 873,440.164 NORTHING (Y) _____
 EASTING (X) 641,183.680 EASTING (X) _____
3RD ORDER COORDINATES STATE AND ZONE FLORIDA, MERCATOR WEST

FIELD BOOK HB PAGE 68 SKETCH BY DSW

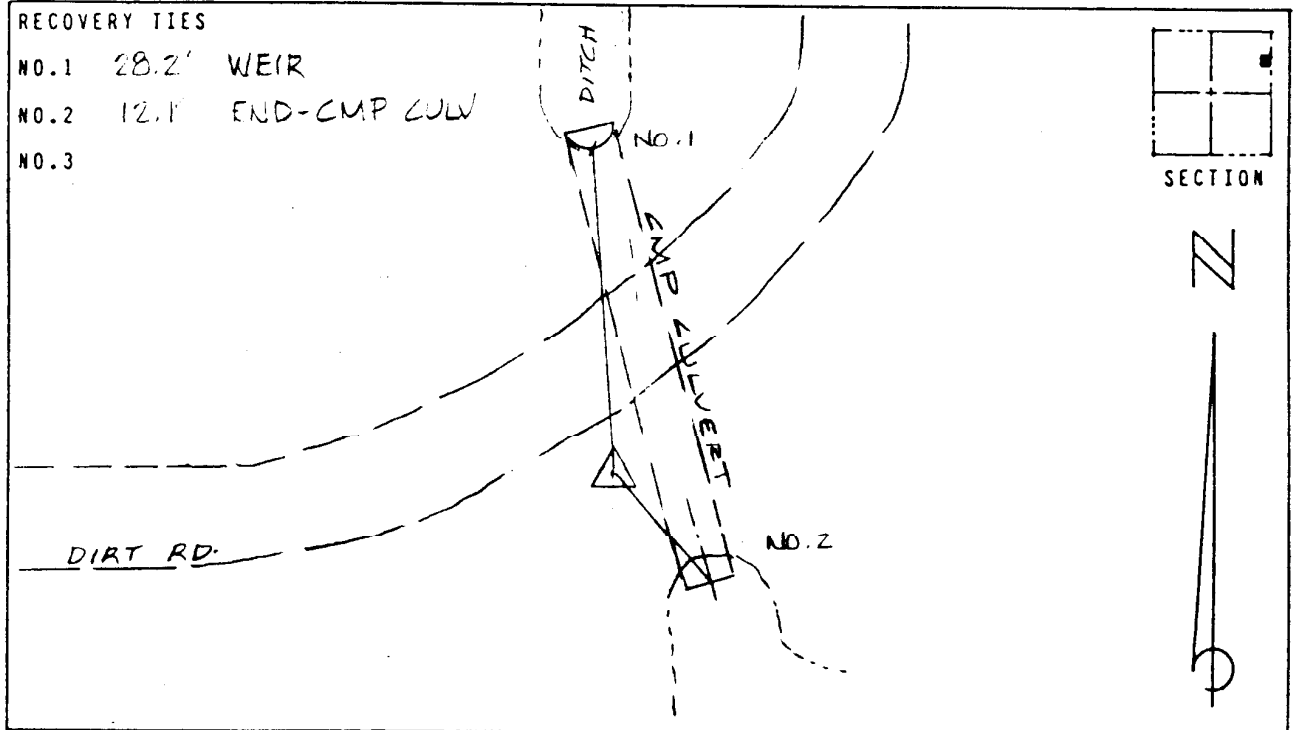

VERTICAL CONTROL ORIGINATED ON 2ND ORDER CONTROL ESTABLISHED BY N.G.S. AND F.D.O.T.
 ON NATIONAL GEODETIC VERTICAL DATUM OF 1929
 ELEVATION (FT): 17.98 . 3RD ORDER LEVEL BOOK V 17 PAGE 41