



Deni Associates
FORT MYERS, FLORIDA

LEE COUNTY, FLORIDA
AERIAL MAPPING PROJECT
MAPPING BY: HAMRICK AERIAL SURVEYS, INC.
CLEARWATER, FLORIDA

DESIGNATION TBM 17-6 COUNTY LEE STATE FL
LOCATED IN SEC 19 TWP 43 S. RGE 27 E USGS QUAD MAP OLGA 7.5 MIN.
TO REACH SURVEY MARK FROM THE INT. OF S.R. 31 & C.R. 78 (N. RIVER RD.):
GO E. 7.05 MI.± TO MARK

TYPE OF MARK RR SPIKE IN N. FACE OF PINE DATE SET MAY 19 85

HORIZONTAL CONTROL ORIGINATED ON _____ ORDER CONTROL ESTABLISHED BY _____
IN _____, ON NORTH AMERICAN DATUM OF 1927.

COORDINATES (FT) NORTH (Y) _____ EAST (X) _____
3RD ORDER STATE AND ZONE FLORIDA, MERCATOR WEST

REFERENCE BEARINGS TO STATION OR OBJECT

| DESCRIPTION | BEARING | DISTANCE |
|-------------|---------|----------|
| _____ | _____ | _____ |
| _____ | _____ | _____ |
| _____ | _____ | _____ |

FIELD BOOK _____ PAGE _____ SKETCH BY FVS

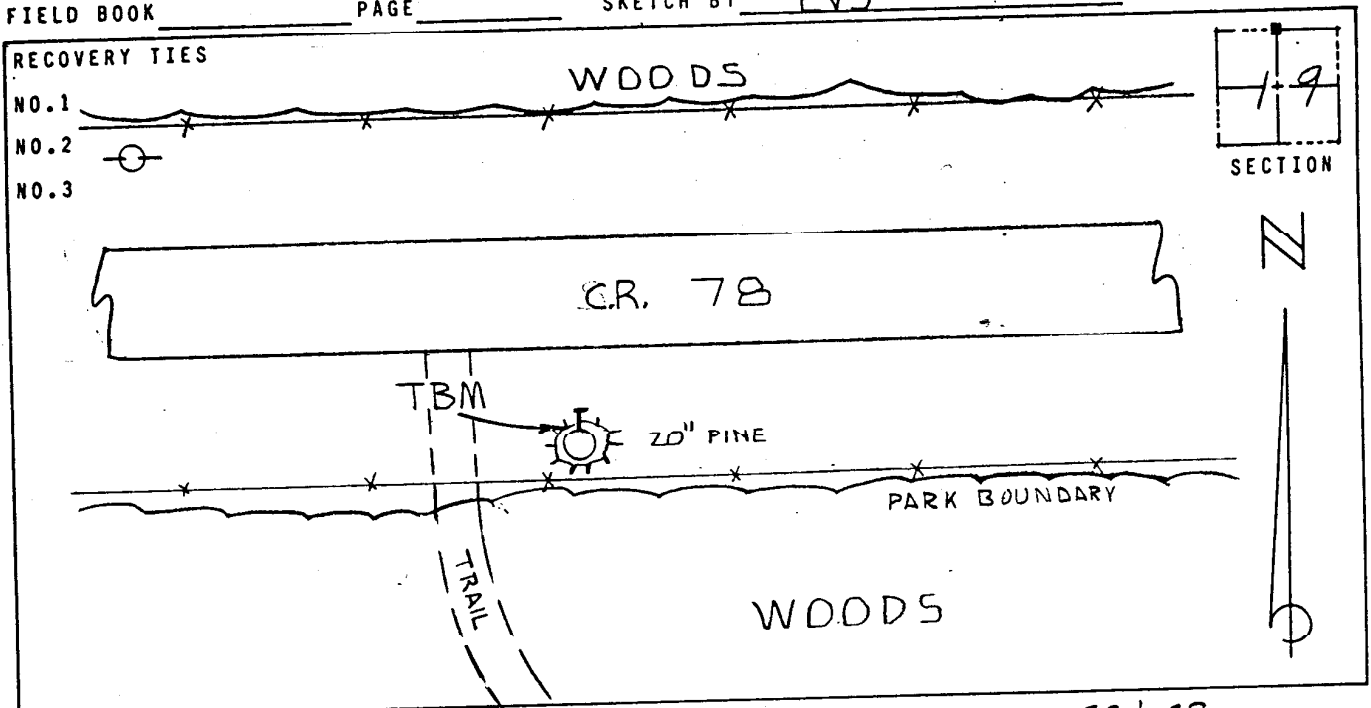

VERTICAL CONTROL ORIGINATED ON 1ST ORDER CONTROL ESTABLISHED BY USC & GS
IN 1966, ON NATIONAL GEODETIC SURVEY DATUM OF 1929.

ELEVATION (FT) 18.08, 3RD ORDER LEVEL BOOK 17 PAGE 6