



Deni Associates
FORT MYERS, FLORIDA

LEE COUNTY, FLORIDA
AERIAL MAPPING PROJECT

MAPPING BY:
WOOLPERT CONSULTANTS

DESIGNATION LH 63 & TBM COUNTY LEE STATE FL.
LOCATED IN SEC 12 TWP 43 S. RGE 27 E. USGS QUAD MAP ALVA
TO REACH SURVEY MARK FROM CR 78 & LEE/HENRY CO LINE; THENCE N'LY 0.6
MILES TO GROVE ENT; THENCE N'LY 0.75 MILES TO T INT; THENCE
W'LY 0.3 MILES TO T INT; THENCE N'LY 0.5 MILES TO MARK.

TYPE OF 2" ALUM. CAP ON RE-BAR
MARK 2" BLU. GRD. DATE SET JULY 1988
HORIZONTAL CONTROL ORIGINATED ON 2ND ORDER CONTROL BY N.G.S. AND F.D.O.T.
ON NORTH AMERICAN DATUM OF 1911 (1921 ADJ) ON NORTH AMERICAN DATUM OF 1983
COORDINATES (FT) COORDINATES (FT)
NORTHING (Y) 876,249.269 NORTHING (Y) _____
EASTING (X) 636,181.588 EASTING (X) _____
3RD ORDER COORDINATES STATE AND ZONE FLORIDA, MERCATOR WEST

FIELD BOOK H 9 PAGE 4 SKETCH BY CHG

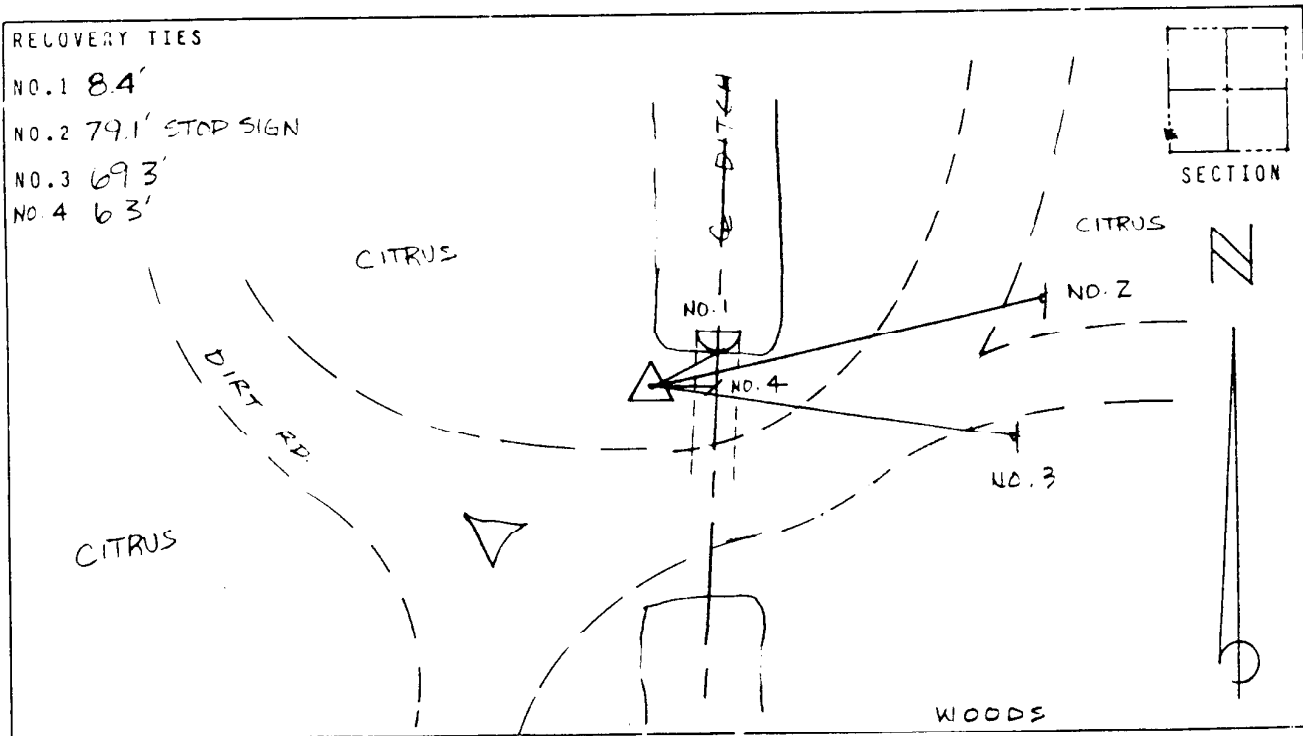

VERTICAL CONTROL ORIGINATED ON 2ND ORDER CONTROL ESTABLISHED BY N.G.S. AND F.D.O.T.
ON NATIONAL GEODETIC VERTICAL DATUM OF 1929
ELEVATION (FT) 19.94 , 3RD ORDER LEVEL BOOK V 17 PAGE 46