



LEE COUNTY, FLORIDA  
AERIAL MAPPING PROJECT

MAPPING BY:  
WOOLPERT CONSULTANTS

DESIGNATION LH 59 & TBM COUNTY LEE STATE FL  
LOCATED IN SEC 1 TWP 43 S. RGE 27 E. USGS QUAD MAP TELEGRAPH SWAMP SE  
TO REACH SURVEY MARK FROM CR 78 & LEE/HENDRY CO LINE; THENCE W'LY 0.6 MILE  
TO GROVE FRT; THENCE N'LY 0.75 MILES TO T INT; THENCE E'LY 0.7 MILE  
TO DORCE NORTH; THENCE N'LY 1.5 MILES TO GROVE ROAD; THENCE  
W'LY 0.35 MILES TO MARK.

TYPE OF 2" ALUM. CAP ON RE-BAR  
MARK 2" BLW. GRD. DATE SET JULY 1988

HORIZONTAL CONTROL ORIGINATED ON 2ND ORDER CONTROL BY N.G.S. AND F.D.O.T.  
ON NORTH AMERICAN DATUM OF 1927 (1927 ADJ) ON NORTH AMERICAN DATUM OF 1983

COORDINATES (FT) COORDINATES (FT)  
NORTHING (Y) 831,446.752 NORTHING (Y) \_\_\_\_\_  
EASTING (X) 639,699.359 EASTING (X) \_\_\_\_\_

3RD ORDER COORDINATES STATE AND ZONE FLORIDA, MERCATOR WEST

FIELD BOOK H 8 PAGE 72 SKETCH BY CHG

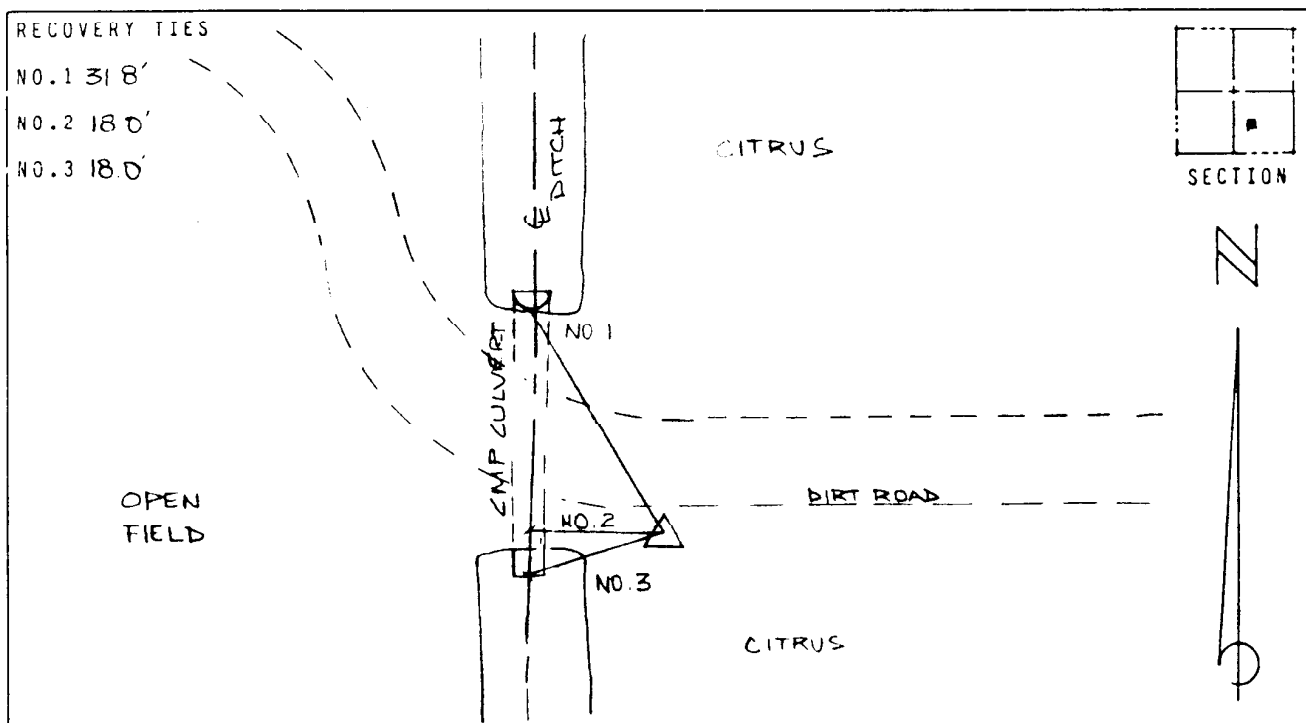

VERTICAL CONTROL ORIGINATED ON 2ND ORDER CONTROL ESTABLISHED BY N.G.S. AND F.D.O.T.

ON NATIONAL GEODETIC VERTICAL DATUM OF 1929  
ELEVATION (FT) 20.87 , 3RD ORDER LEVEL BOOK V 17 PAGE 48