

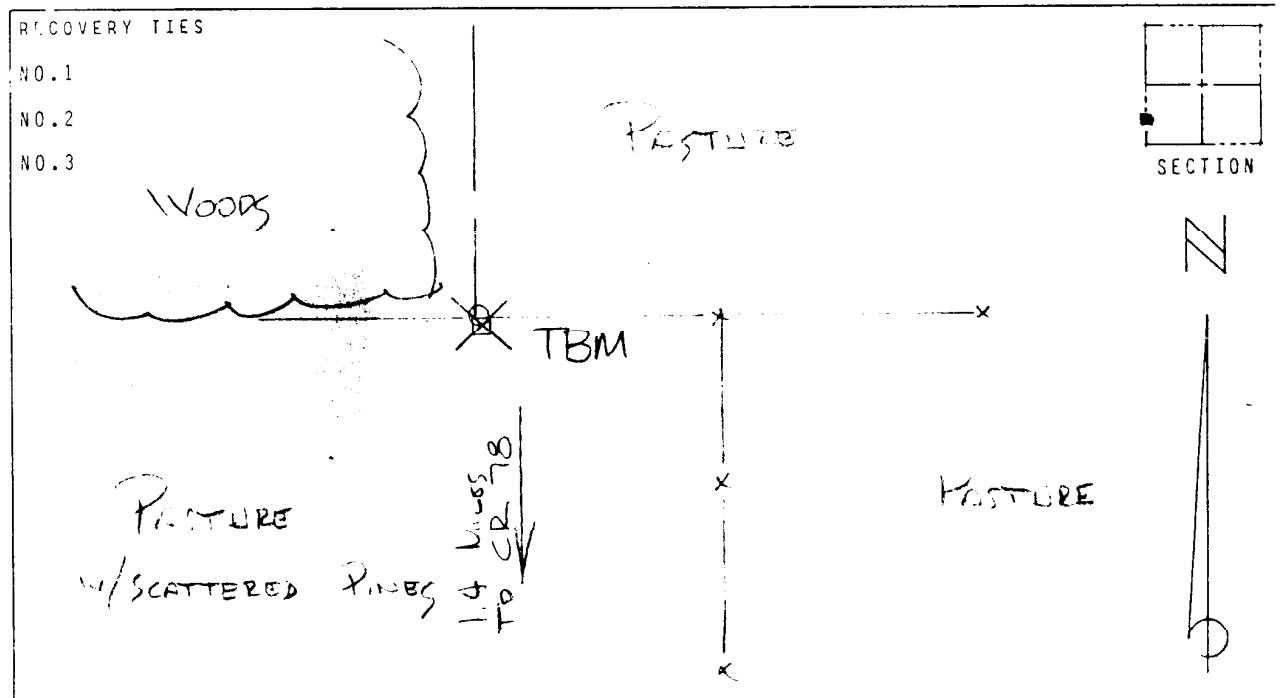

LEE COUNTY, FLORIDA  
AERIAL MAPPING PROJECT  
MAPPING BY:  
WOOLPERT CONSULTANTS

DESIGNATION TBM 17-63 COUNTY LEE STATE FL  
LOCATED IN SEC 10 TWP 43 S. RGE 27 E. USGS QUAD MAP ALVA  
TO REACH SURVEY MARK FROM INT OF CR 7B (N. RIVER ROAD)  
& PARKINSON ROAD, NORTHWEST OF ALVA; THENCE  
NORTH FOR 1.3 Miles TO THE END OF THE ROAD,  
THENCE BY FOOT THROUGH A PASTURE FOR 235 FT  
TO POINT OF LINE & MARK.  
TYPE OF 3x3 CONCRETE SURVEY MONUMENT.  
MARK \_\_\_\_\_ DATE SET JULY 1988  
HORIZONTAL CONTROL ORIGINATED ON 2ND ORDER CONTROL BY N.G.S. AND F.D.O.T.  
ON NORTH AMERICAN DATUM OF 1927 (1927 ADJ) ON NORTH AMERICAN DATUM OF 1983  
COORDINATES (FT) COORDINATES (FT)  
NORTHING (Y) \_\_\_\_\_ NORTHING (Y) \_\_\_\_\_  
EASTING (X) \_\_\_\_\_ EASTING (X) \_\_\_\_\_  
3RD ORDER COORDINATES STATE AND ZONE FLORIDA, MERCATOR WEST

FIELD BOOK \_\_\_\_\_ PAGE \_\_\_\_\_ SKETCH BY RLV



VERTICAL CONTROL ORIGINATED ON 2ND ORDER CONTROL ESTABLISHED BY N.G.S. AND F.D.O.T.  
ON NATIONAL GEODETIC VERTICAL DATUM OF 1929  
ELEVATION (FT) 19.14 . 3RD ORDER LEVEL BOOK V 17 PAGE 63