

E 762,000 E 763,000 E 764,000 E 765,000 E 766,000 E 767,000











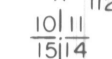

COMPILED BY PHOTOGRAMMETRIC METHODS

WOOLPERT CONSULTANTS
DAYTON & CINCINNATI, OHIO CHARLOTTE, NORTH CAROLINA
MOBILE, ALABAMA ORLANDO & PENSACOLA, FLORIDA

GEODETIC CONTROL SURVEY BY

Deni Associates
FT. MYERS, FLORIDA

LEGEND

- HORIZONTAL CONTROL U.S.C. & G.S. 
- FLORIDA STATE DEPT. OF TRANSPORTATION 
- TRAVERSE STATIONS 
- VERTICAL CONTROLS 
- SECTION CORNERS 
- CONTOURS 
- DEPRESSION CONTOURS 
- SPOT ELEVATIONS 
- STATE ROUTE 
- U.S. ROUTE 
- INTERSTATE HIGHWAY 
- POLITICAL BOUNDARIES 

LOCATION MAP

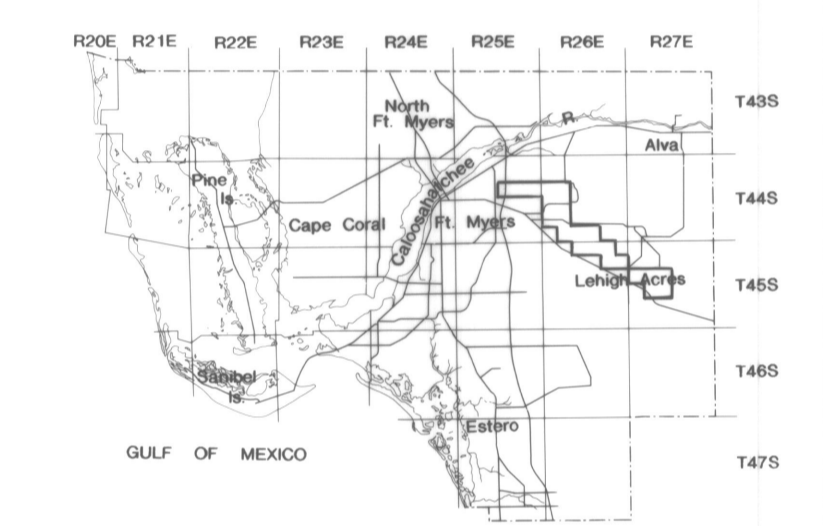

KEY MAP

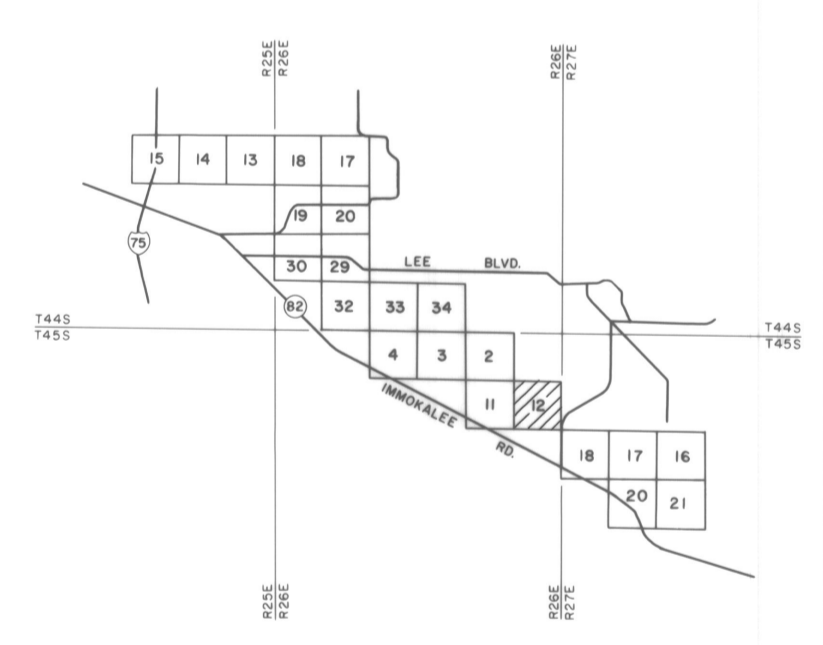

NOTE:

ACCURACY: THIS MAPPING IS INTENDED TO COMPLY WITH NATIONAL MAP ACCURACY STANDARDS. HOWEVER, SUCH ACCURACY OR ANY OTHER LEVEL OF ACCURACY, IS NOT GUARANTEED BY LEE COUNTY, FLORIDA.

THE LAND LINE INFORMATION SHOWN IS DERIVED FROM THE BEST AVAILABLE DATA AND DOES NOT NECESSARILY REPRESENT TRUE LAND LINE LOCATION.

DASHED CONTOURS AND UNDERLINED ELEVATIONS INDICATE STANDARD VERTICAL ACCURACY REDUCED BY TREE COVER.

THIS SHEET MAY NOT BE REPRODUCED, IN PART OR IN FULL, WITHOUT SPECIFIC APPROVAL OF THE DIVISION OF LAND INFORMATION SYSTEMS, LEE COUNTY, LEE COUNTY COURTHOUSE, 2115 SECOND STREET, FT. MYERS, FLORIDA.

COPYRIGHT BY LEE COUNTY, FLORIDA. ALL RIGHTS RESERVED.

GRIDS BASED ON THE FLORIDA STATE PLANE COORDINATE SYSTEM, WEST ZONE.

ELEVATIONS BASED ON U.S.C. & G.S. DATUM.



SCALE 1" = 200' CONTOUR INTERVAL 1'
DATE OF BASE PHOTOGRAPHY FEBRUARY 1991
DATE OF MAPPING PHOTOGRAPHY APRIL 1990

LEE COUNTY
FT. MYERS, FLORIDA

LAND INFORMATION SYSTEMS

SECTION 12 TOWNSHIP 45 SOUTH RANGE 26 EA

DRAWING NUMBER SHEET OF

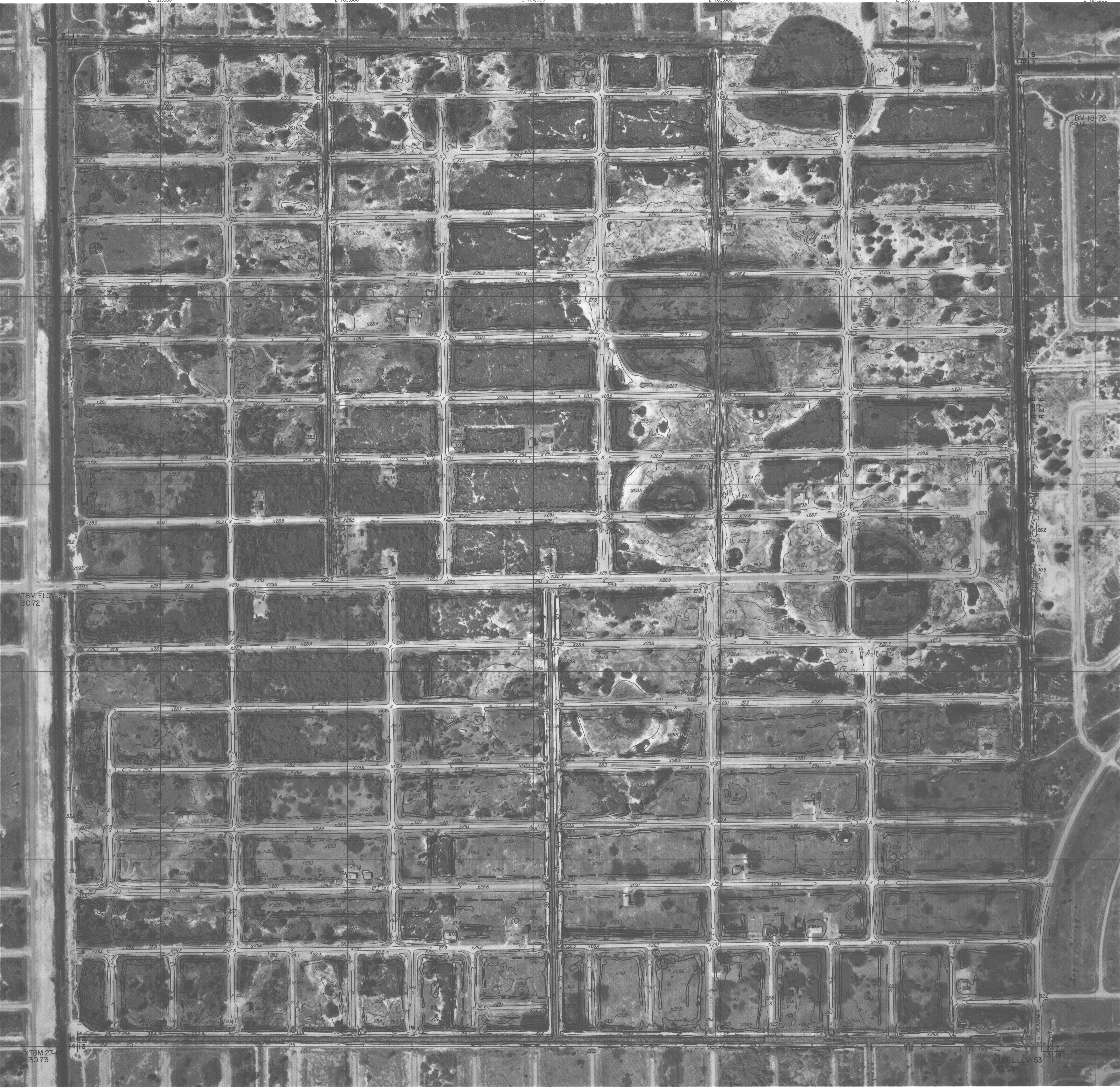

XTBM ELEV. 37
30.72

XTBM 27-
30.73

XTBM 18-72
29.44

XTBM ELEV. 53
30.33

12-45-26