

N 797,000  
N 796,000  
N 795,000  
N 794,000  
N 793,000  
N 792,000

COMPILED BY PHOTOGRAMMETRIC METHODS BY  
**GEOGRAPHIC INFORMATION SERVICES**  
 WOOLPERT

GEODETIC CONTROL SURVEY BY  
 Dent Assoc  
 FT. MYERS, FLOR.

**LEGEND**

- HORIZONTAL CONTROL U.S.C.&G.S.
- FLORIDA STATE DEPT. OF TRANSPORTATION
- TRAVERSE STATIONS
- VERTICAL CONTROLS
- SECTION CORNERS
- CONTOURS
- DEPRESSION CONTOURS
- SPOT ELEVATIONS
- STATE ROUTE
- U.S. ROUTE
- INTERSTATE HIGHWAY
- POLITICAL BOUNDARIES

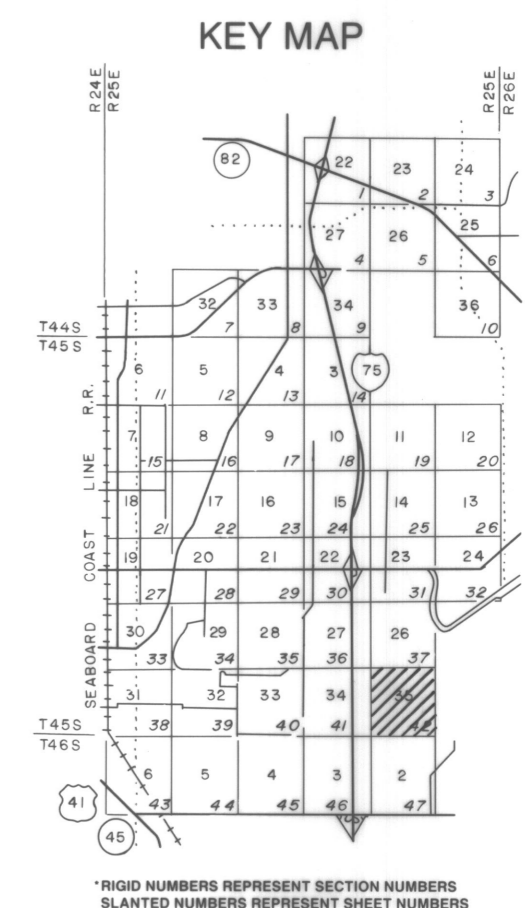

**NOTE:**

ACCURACY: THIS MAPPING IS INTENDED TO COMPLY WITH NATIONAL MAP ACCURACY STANDARDS. HOWEVER, SUCH ACCURACY, OR ANY OTHER LEVEL OF ACCURACY, IS NOT GUARANTEED BY LEE COUNTY, FLORIDA. THE LAND LINE INFORMATION SHOWN IS COMPILED FROM THE BEST AVAILABLE DATA AND DOES NOT NECESSARILY REPRESENT TRUE LAND LINE LOCATION.

CONTOUR LINES ARE DIGITALLY COMPILED BY PHOTOGRAMMETRIC METHODS TO NATIONAL MAP ACCURACY STANDARDS; HOWEVER, THEY DO NOT NECESSARILY FIT THE HORIZONTAL POSITION OF THE PHOTOGRAPHIC IMAGE DUE TO RELIEF DISPLACEMENT.

DASHED CONTOURS AND UNDERLINED ELEVATIONS INDICATE STANDARD VERTICAL ACCURACY REDUCED BY TREE COVER.

THIS SHEET MAY NOT BE REPRODUCED, IN PART OR IN FULL, WITHOUT SPECIFIC APPROVAL OF THE DIVISION OF LAND INFORMATION SYSTEMS, LEE COUNTY, FLORIDA.

L.S.S. SW  
 1009 HEITMAN ST.  
 FT. MYERS, FLORIDA  
 ALL RIGHTS RESERVED

GRIDS BASED ON THE FLORIDA STATE PLANE COORDINATE SYSTEM, NAD, 1983  
 ELEVATIONS BASED ON U.S.C.&G.S. DATUM.

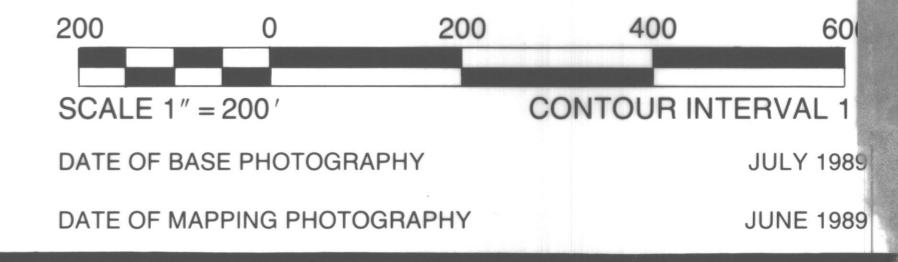

LEE COUNTY  
 FT. MYERS, FLORIDA

**SIX MILE CYPRESS / TEN MILE BASIN  
 LAND INFORMATION SYSTEMS**

SECTION 35 TOWNSHIP 45 SOUTH RANGE 25 EAST  
 DRAWING NUMBER SHEET 42 OF 42

35-45-25