

COMPILED BY PHOTOGRAMMETRIC METHODS BY
W **GEOGRAPHIC INFORMATION SERVICES**
 WOOLPERT

GEODETIC CONTROL SURVEY BY
 Dent Rescorta
 FT. MYERS, FLORIDA

LEGEND

- HORIZONTAL CONTROL U.S.C.&G.S. △
- FLORIDA STATE DEPT. OF TRANSPORTATION ○
- TRAVERSE STATIONS ○
- VERTICAL CONTROLS ○
- SECTION CORNERS ○
- CONTOURS —
- DEPRESSION CONTOURS —
- SPOT ELEVATIONS ○
- STATE ROUTE ○
- U.S. ROUTE ○
- INTERSTATE HIGHWAY ○
- POLITICAL BOUNDARIES —

N 756,000
N 755,000
N 754,000
N 753,000
N 752,000

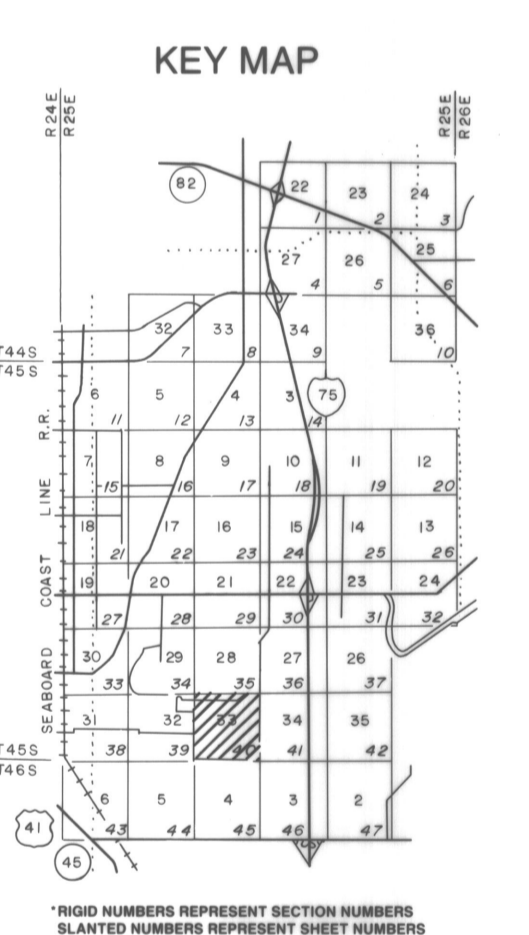

NOTE:

ACCURACY: THIS MAPPING IS INTENDED TO COMPLY WITH NATIONAL MAP ACCURACY STANDARDS. HOWEVER, SUCH ACCURACY OR ANY OTHER LEVEL OF ACCURACY IS NOT GUARANTEED BY LEE COUNTY, FLORIDA.

THE LAND LINE INFORMATION SHOWN IS COMPILED FROM THE BEST AVAILABLE DATA AND DOES NOT NECESSARILY REPRESENT TRUE LAND LINE LOCATION.

CONTOUR LINES ARE DIGITALLY COMPILED BY PHOTOGRAMMETRIC METHODS TO NATIONAL MAP ACCURACY STANDARDS; HOWEVER, THEY DO NOT NECESSARILY FIT THE HORIZONTAL POSITION OF THE PHOTOGRAPHIC IMAGE DUE TO RELIEF DISPLACEMENT.

DASHED CONTOURS AND UNDERLINED ELEVATIONS INDICATE STANDARD VERTICAL ACCURACY REDUCED BY TREE COVER.

THIS SHEET MAY NOT BE REPRODUCED, IN PART OR IN FULL, WITHOUT SPECIFIC APPROVAL OF THE DIVISION OF LAND INFORMATION SYSTEMS, LEE COUNTY.

L.L.S. 011
 1609 HEITMAN ST.
 FT. MYERS, FLORIDA

COPYRIGHTED BY LEE COUNTY, FLORIDA.
 ALL RIGHTS RESERVED.

GRIDS BASED ON THE FLORIDA STATE PLANE COORDINATE SYSTEM, NAD, 1983.
 ELEVATIONS BASED ON U.S.C.&G.S. DATUM.

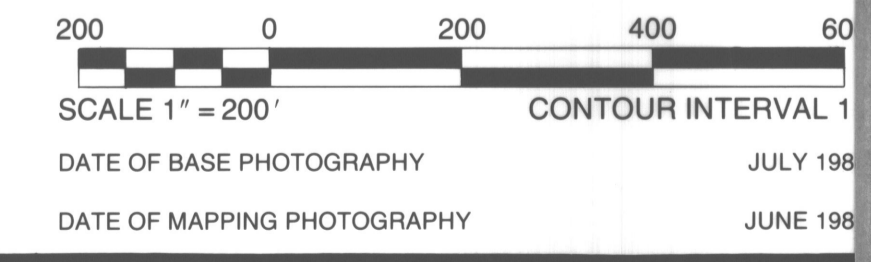

LEE COUNTY
 FT. MYERS, FLORIDA

**SIX MILE CYPRESS / TEN MILE BASIN
 LAND INFORMATION SYSTEMS**

SECTION 33 TOWNSHIP 45 SOUTH RANGE 25 EAST
 DRAWING NUMBER SHEET 40 OF 40

33-45-25