

E 720,000

E 720,000

E 722,000

E 723,000

E 724,000

E 725,000

COMPILED BY PHOTOGRAMMETRIC METHODS BY

GEODETTIC CONTROL BY



LEGEND

- HORIZONTAL CONTROL U.S.C.&G.S.
- FLORIDA STATE DEPT. OF TRANSPORTATION
- TRAVERSE STATIONS
- VERTICAL CONTROLS
- SECTION CORNERS
- CONTOURS
- DEPRESSION CONTOURS
- SPOT ELEVATIONS
- STATE ROUTE
- U.S. ROUTE
- INTERSTATE HIGHWAY
- POLITICAL BOUNDARIES



KEY MAP

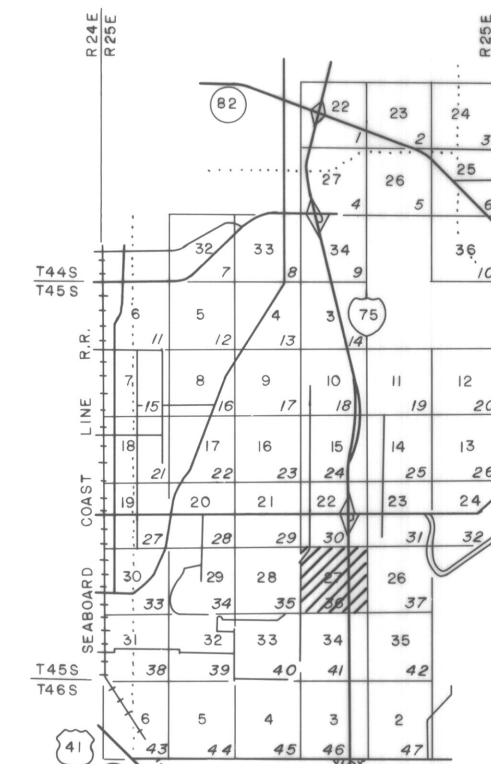

THICK NUMBERS REPRESENT SECTION NUMBERS  
SLANTED NUMBERS REPRESENT SHEET NUMBERS

NOTE:

ACCURACY: THIS MAPPING IS INTENDED TO COMPLY WITH NATIONAL MAP ACCURACY STANDARDS. HOWEVER, SUCH ACCURACY, OR ANY OTHER LEVEL OF ACCURACY, IS NOT GUARANTEED BY LEE COUNTY, FLORIDA.

THE LAND LINE INFORMATION SHOWN IS COMPILED FROM THE BEST AVAILABLE DATA AND DOES NOT NECESSARILY REPRESENT TRUE LAND LINE LOCATION.

CONTOUR LINES ARE DIGITALLY COMPILED BY PHOTOGRAMMETRIC METHODS TO NATIONAL MAP ACCURACY STANDARDS. HOWEVER, THEY DO NOT NECESSARILY FIT THE HORIZONTAL POSITION OF THE PHOTOGRAPHIC IMAGE DUE TO RELIEF DISPLACEMENT.

DASHED CONTOURS AND UNDERLINED ELEVATIONS INDICATE STANDARD VERTICAL ACCURACY REDUCED BY TREE COVER.

THIS SHEET MAY NOT BE REPRODUCED, IN PART OR IN FULL, WITHOUT SPECIFIC APPROVAL OF THE DIVISION OF LAND INFORMATION SYSTEMS, LEE COUNTY.

L. S. DENI  
1609 HEITMAN ST.  
FT. MYERS, FLORIDA  
ALL RIGHTS RESERVED

GRIDS BASED ON THE FLORIDA STATE PLANE COORDINATE SYSTEM, NAD, 1983  
ELEVATIONS BASED ON U.S.C.&G.S. DATUM.

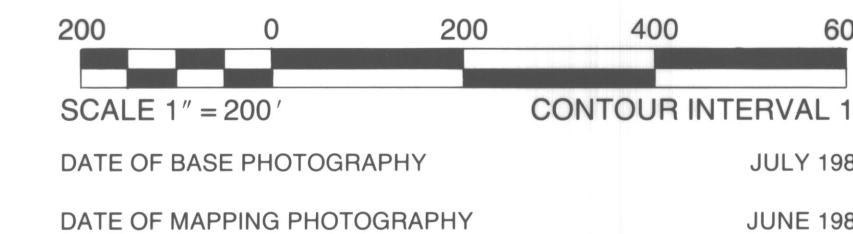

LEE COUNTY FT. MYERS, FLORIDA

SIX MILE CYPRESS / TEN MILE BASIN LAND INFORMATION SYSTEMS

SECTION 27 TOWNSHIP 45 SOUTH RANGE 25 EAST  
DRAWING NUMBER SHEET 36 OF 4

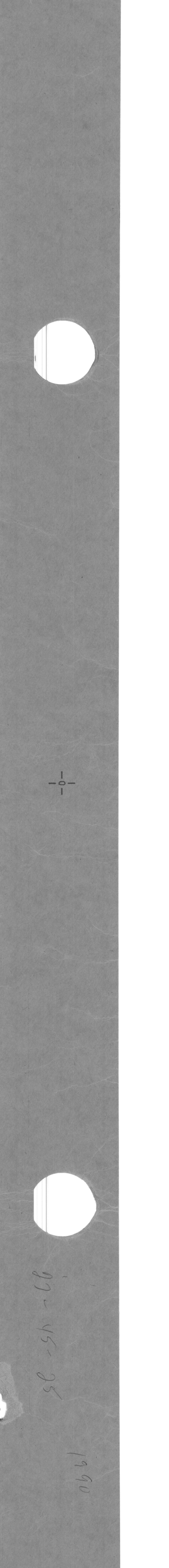

Handwritten notes: 20-57, 23.39, 27.26, 24.35, 0661