

E 709,000 E 710,000 E 711,000 E 712,000 E 713,000 E 714,000

N 862,000  
N 863,000  
N 864,000  
N 865,000  
N 866,000  
N 867,000



COMPILED BY PHOTOGRAMMETRIC METHODS BY  
**GEOGRAPHIC INFORMATION SERVICES**  
 WOODBERT

GEODETIC CONTROL SURVEY BY  
 Dent Assoc  
 FT. MYERS, FLOR.

**LEGEND**

HORIZONTAL CONTROL U.S.C.&G.S.

FLORIDA STATE DEPT. OF TRANSPORTATION

TRAVERSE STATIONS

VERTICAL CONTROLS

SECTION CORNERS

CONTOURS

DEPRESSION CONTOURS

SPOT ELEVATIONS

STATE ROUTE

U.S. ROUTE

INTERSTATE HIGHWAY

POLITICAL BOUNDARIES

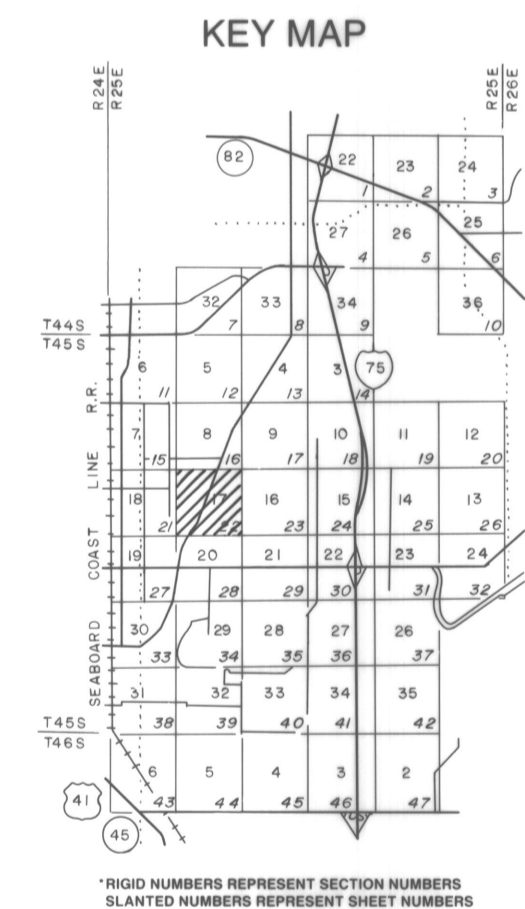

**NOTE:**

ACCURACY: THIS MAPPING IS INTENDED TO COMPLY WITH NATIONAL MAP ACCURACY STANDARDS. HOWEVER, SUCH ACCURACY OR ANY OTHER LEVEL OF ACCURACY IS NOT GUARANTEED BY LEE COUNTY, FLORIDA.

THE LAND LINE INFORMATION SHOWN IS COMPILED FROM THE BEST AVAILABLE DATA AND DOES NOT NECESSARILY REPRESENT THE LAND LINE LOCATION.

CONTOUR LINES ARE DIGITALLY COMPILED BY PHOTOGRAMMETRIC METHODS TO NATIONAL MAP ACCURACY STANDARDS. HOWEVER, THEY DO NOT NECESSARILY FIT THE HORIZONTAL POSITION OF THE PHOTOGRAPHIC IMAGE DUE TO RELIEF DISPLACEMENT.

DASHED CONTOURS AND UNDERLINED ELEVATIONS INDICATE STANDARD VERTICAL ACCURACY REDUCED BY TREE COVER.

THIS SHEET MAY NOT BE REPRODUCED, IN PART OR IN FULL, WITHOUT SPECIFIC APPROVAL OF THE DIVISION OF LAND INFORMATION SYSTEMS, LEE COUNTY.

U.S.G. 1609 HEITMAN ST.  
 FT. MYERS, FLORIDA.

COPYRIGHTED BY LEE COUNTY, FLORIDA.  
 ALL RIGHTS RESERVED.

GRIDS BASED ON THE FLORIDA STATE PLANE COORDINATE SYSTEM 1403, 1983.  
 ELEVATIONS BASED ON U.S.C.&G.S. DATUM.

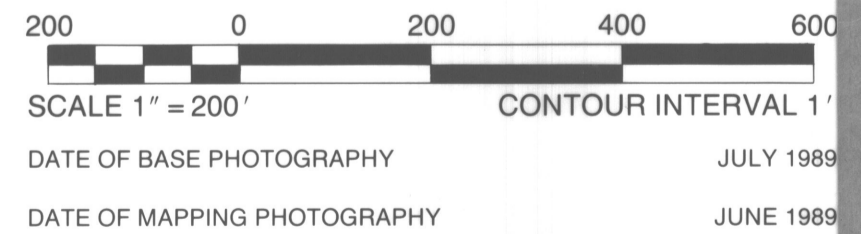

LEE COUNTY  
 FT. MYERS, FLORIDA

**SIX MILE CYPRESS / TEN MILE BASIN  
 LAND INFORMATION SYSTEMS**

SECTION 17 TOWNSHIP 45 SOUTH RANGE 25 EAST

DRAWING NUMBER SHEET 22 OF 4

17-45-25  
 1998