

E 730,000 E 731,000 E 732,000 E 733,000 E 734,000 E 735,000



COMPILED BY PHOTOGRAMMETRIC METHODS BY GEOGRAPHIC INFORMATION SERVICES



GEODETIC CONTROL BY DENI ASSOCIATES, FT. MYERS, FL.



LEGEND

- HORIZONTAL CONTROL U.S.C.&G.S.
- FLORIDA STATE DEPT. OF TRANSPORTATION
- TRAVERSE STATIONS
- VERTICAL CONTROLS
- SECTION CORNERS
- CONTOURS
- DEPRESSION CONTOURS
- SPOT ELEVATIONS
- STATE ROUTE
- U.S. ROUTE
- INTERSTATE HIGHWAY
- POLITICAL BOUNDARIES

KEY MAP

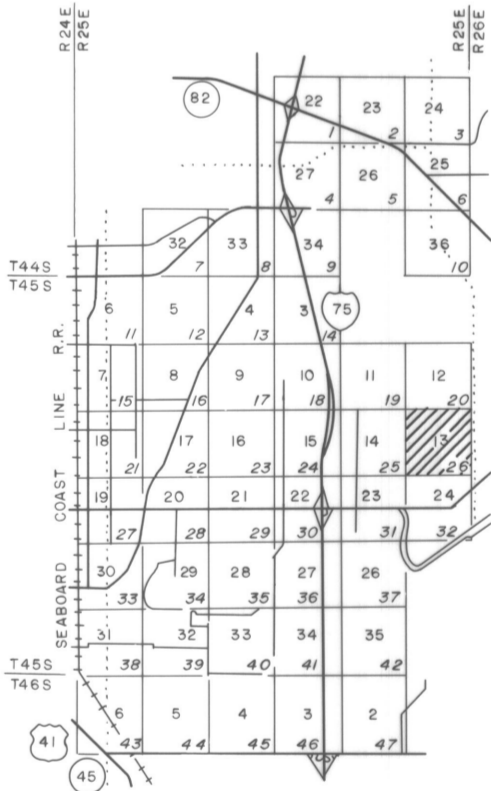

NOTE:

ACCURACY: THIS MAPPING IS INTENDED TO COMPLY WITH NATIONAL MAP ACCURACY STANDARDS. HOWEVER, SUCH ACCURACY, OR ANY OTHER LEVEL OF ACCURACY, IS NOT GUARANTEED BY LEE COUNTY, FLORIDA.

THE LAND LINE INFORMATION SHOWN IS COMPILED FROM THE BEST AVAILABLE DATA AND DOES NOT NECESSARILY REPRESENT TRUE LAND LINE LOCATION.

CONTOUR LINES ARE DIGITALLY COMPILED BY PHOTOGRAMMETRIC METHODS TO NATIONAL MAP ACCURACY STANDARDS. HOWEVER, THEY DO NOT NECESSARILY FIT THE HORIZONTAL POSITION OF THE PHOTOGRAMMETRIC IMAGE DUE TO RELIEF DISPLACEMENT.

DASHED CONTOURS AND UNDERLINED ELEVATIONS INDICATE STANDARD VERTICAL ACCURACY REDUCED BY TREE COVER.

THIS SHEET MAY NOT BE REPRODUCED, IN PART OR IN FULL, WITHOUT SPECIFIC APPROVAL OF THE DIVISION OF LAND INFORMATION SYSTEMS, LEE COUNTY, FLORIDA.

U.S. DIV. 1609 HETMAN ST. FT. MYERS, FLORIDA.

COPYRIGHTED BY LEE COUNTY, FLORIDA. ALL RIGHTS RESERVED.

GRIDS BASED ON THE FLORIDA STATE PLANE COORDINATE SYSTEM, NAD, 1983.

ELEVATIONS BASED ON U.S.C.&G.S. DATUM.

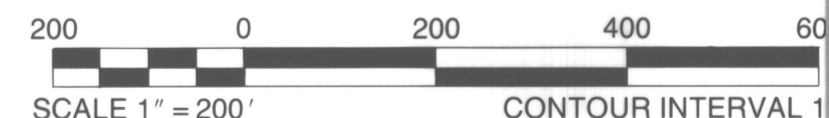

DATE OF BASE PHOTOGRAPHY JULY 1988
DATE OF MAPPING PHOTOGRAPHY JUNE 1988

LEE COUNTY
FT. MYERS, FLORIDA

SIX MILE CYPRESS / TEN MILE BASIN
LAND INFORMATION SYSTEMS

SECTION 13 TOWNSHIP 45 SOUTH RANGE 25 EAST

DRAWING NUMBER SHEET 26 OF 4

13-45-25