

E 719,000 E 720,000 E 721,000 E 722,000 E 723,000 E 724,000

COMPILED BY PHOTOGRAMMETRIC METHODS GEODETIC CONTROL SURVEY BY



LEGEND

HORIZONTAL CONTROL U.S.C.&G.S.	△
FLORIDA STATE DEPT. OF TRANSPORTATION	○
TRAVERSE STATIONS	○
VERTICAL CONTROLS	○
SECTION CORNERS	○
CONTOURS	—
DEPRESSION CONTOURS	—
SPOT ELEVATIONS	50.4
STATE ROUTE	—
U.S. ROUTE	—
INTERSTATE HIGHWAY	—
POLITICAL BOUNDARIES	—

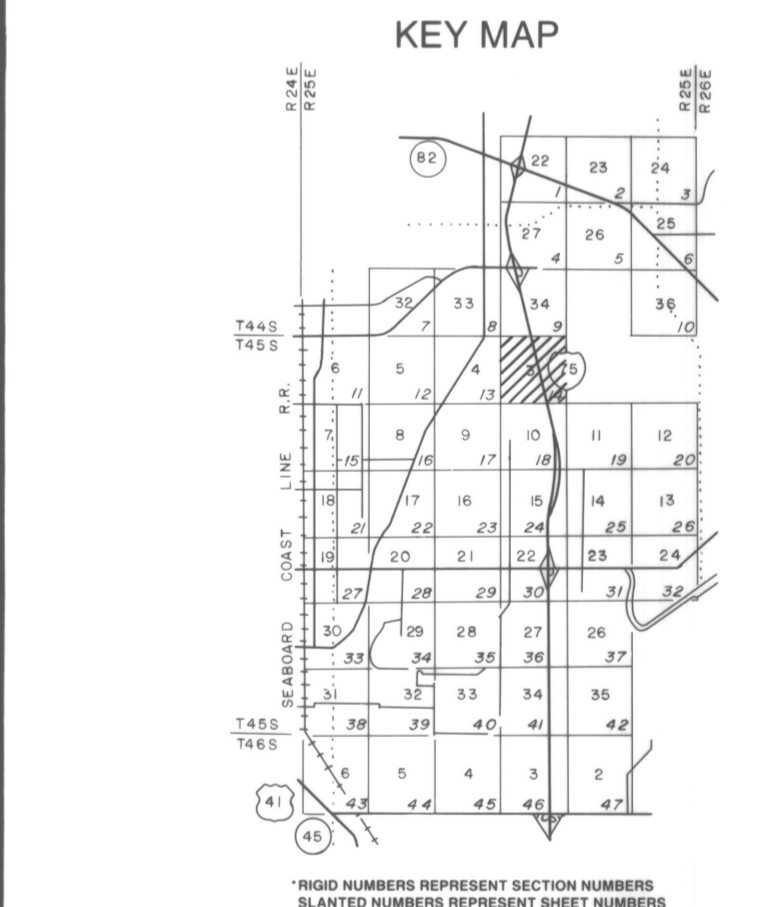

NOTE:

ACCURACY: THIS MAPPING IS INTENDED TO COMPLY WITH NATIONAL MAP ACCURACY STANDARDS. HOWEVER, SUCH ACCURACY OR ANY OTHER LEVEL OF ACCURACY IS NOT GUARANTEED BY LEE COUNTY, FLORIDA.

THE LAND LINE INFORMATION SHOWN IS COMPILED FROM THE BEST AVAILABLE DATA AND DOES NOT NECESSARILY REPRESENT TRUE LAND LINE LOCATION.

CONTOUR LINES ARE DIGITALLY COMPILED BY PHOTOGRAMMETRIC METHODS TO NATIONAL MAP ACCURACY STANDARDS; HOWEVER, THEY DO NOT NECESSARILY FIT THE HORIZONTAL POSITION OF THE PHOTOGRAPHIC IMAGE DUE TO RELIEF DISPLACEMENT.

DASHED CONTOURS AND UNDERLINED ELEVATIONS INDICATE STANDARD VERTICAL ACCURACY REDUCED BY TREE COVER.

THIS SHEET MAY NOT BE REPRODUCED, IN PART OR IN FULL, WITHOUT SPECIFIC APPROVAL OF THE DIVISION OF LAND INFORMATION SYSTEMS, LEE COUNTY.

L.I.S. DIV.
1800 NEETMAN ST.
FT. MYERS, FLORIDA

COPYRIGHTED BY LEE COUNTY, FLORIDA.
ALL RIGHTS RESERVED.

GRIDS BASED ON THE FLORIDA STATE PLANE COORDINATE SYSTEM NAD, 1983.
ELEVATIONS BASED ON U.S.C.&G.S. DATUM.

200 0 200 400 600
SCALE 1" = 200' CONTOUR INTERVAL 1'
DATE OF BASE PHOTOGRAPHY JULY 1988
DATE OF MAPPING PHOTOGRAPHY JUNE 1988

LEE COUNTY
FT. MYERS, FLORIDA

**SIX MILE CYPRESS / TEN MILE BASIN
LAND INFORMATION SYSTEMS**

SECTION 3 TOWNSHIP 45 SOUTH RANGE 25 E
DRAWING NUMBER SHEET 14 OF

3-45-25