



COMPILED BY PHOTOGRAMMETRIC METHODS

BY  
**HAMRICK** • Aerial Surveys, Inc.



CLEARWATER FLORIDA

LEGEND

- HORIZONTAL CONTROL U.S.C.&G.S. △
- TRAVERSE STATIONS 4-5-2 ○
- VERTICAL CONTROLS 9.13 X
- SECTION CORNERS 2 | 1  
11 | 12  
5
- CONTOURS 10  
15
- DEPRESSION CONTOURS 15
- SPOT ELEVATIONS 12.5
- T. B. M. TBM X  
7.2

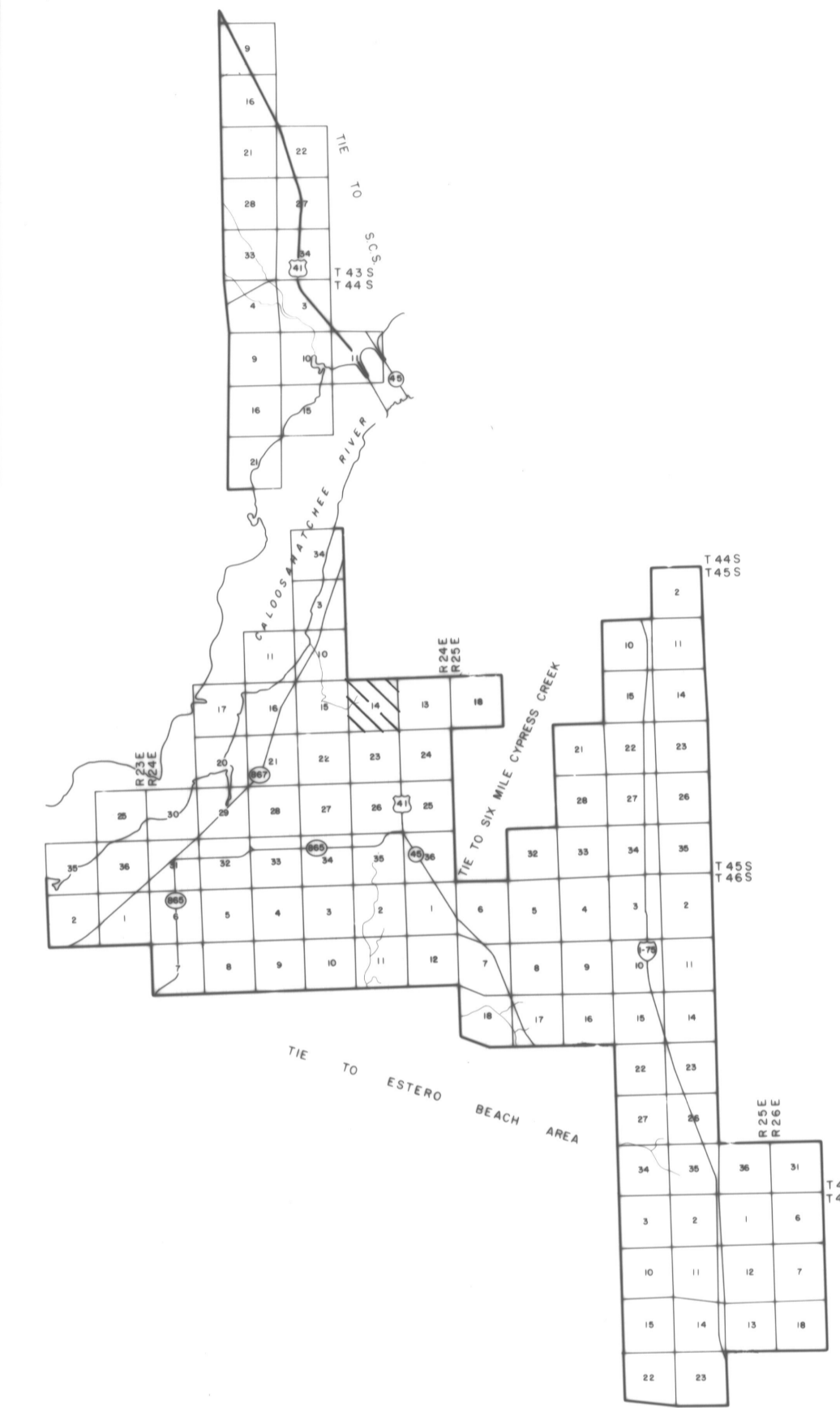

GEODETIC CONTROL SURVEYS

BY  
**Dani Associates**  
FT. MYERS, FLORIDA

**NOTE** ACCURACY: IT IS INTENDED THAT THIS MAPPING COMPLY WITH U.S. NATIONAL MAP ACCURACY STANDARDS HOWEVER SUCH ACCURACY OR ANY OTHER LEVEL OF ACCURACY IS NOT GUARANTEED BY LEE COUNTY FLORIDA



THE LAND LINE INFORMATION SHOWN HERE ON IS COMPILED FROM THE BEST AVAILABLE DATA AND DOES NOT NECESSARILY REPRESENT TRUE LAND LINE LOCATION

DASHED CONTOURS AND UNDERLINED ELEVATIONS INDICATE STANDARD VERTICAL ACCURACY REDUCED BY HEAVY FOLIAGE COVER

GRIDS BASED ON FLORIDA STATE PLANE COORDINATE SYSTEM WEST ZONE

ELEVATIONS BASED ON U.S.C.&G.S. DATUM

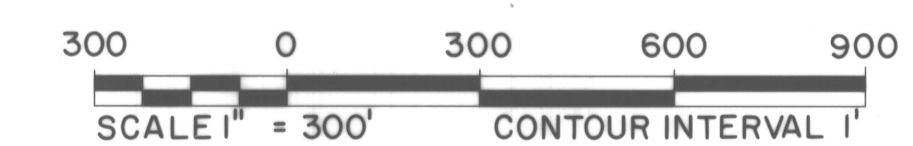

DATE OF PHOTOGRAPHY NOV 81  
DATE OF MAPPING JULY 82

**LEE COUNTY**  
FLORIDA

SECTION 14 T 45 S R 24 E

14-45-24