

E 766,000 E 767,000 E 768,000 E 769,000 E 770,000 E 771,000

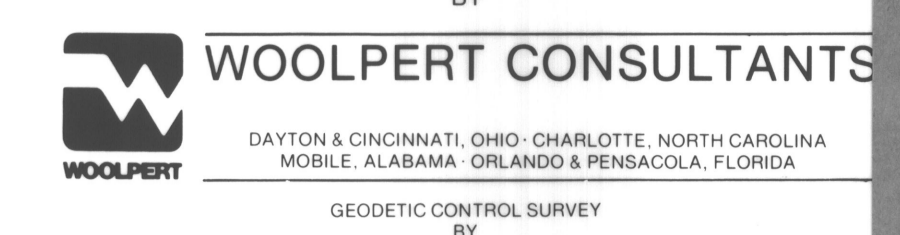

COMPILED BY PHOTOGRAMMETRIC METHODS BY



- LEGEND**
- HORIZONTAL CONTROL U.S.C. & G.S.
  - FLORIDA STATE DEPT. OF TRANSPORTATION
  - TRAVERSE STATIONS
  - VERTICAL CONTROLS
  - SECTION CORNERS
  - CONTOURS
  - DEPRESSION CONTOURS
  - SPOT ELEVATIONS
  - STATE ROUTE
  - U.S. ROUTE
  - INTERSTATE HIGHWAY
  - POLITICAL BOUNDARIES

**LOCATION MAP**

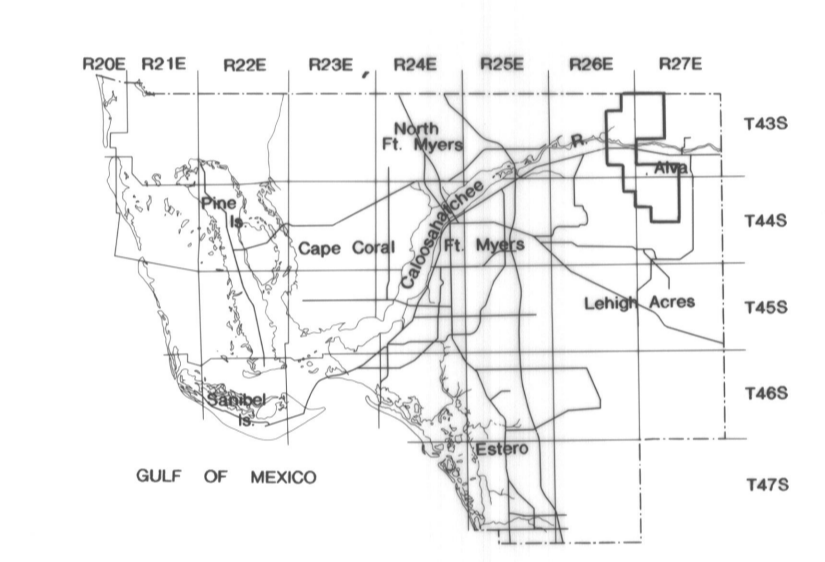

**KEY MAP**

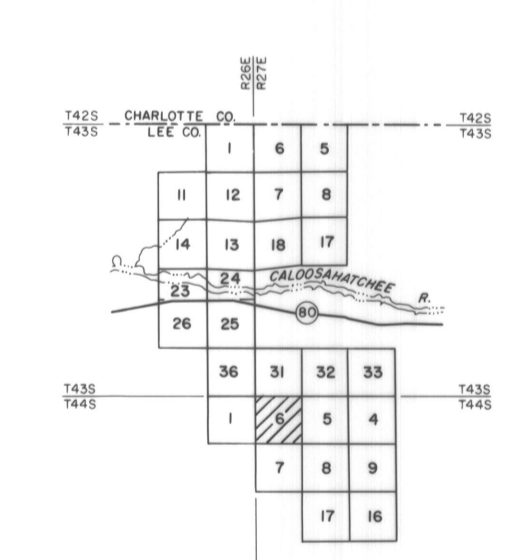

**NOTE:**

ACCURACY: THIS MAPPING IS INTENDED TO COMPLY WITH NATIONAL MAP ACCURACY STANDARDS. HOWEVER, SUCH ACCURACY, OR ANY OTHER LEVEL OF ACCURACY, IS NOT GUARANTEED BY LEE COUNTY, FLORIDA.

THE LAND INFORMATION SHOWN IS COMPILED FROM THE BEST AVAILABLE DATA AND DOES NOT NECESSARILY REPRESENT TRUE LAND LINE LOCATION.

DASHED CONTOURS AND UNDERLINED ELEVATIONS INDICATE STANDARD VERTICAL ACCURACY REDUCED BY TREE COVER.

THIS SHEET MAY NOT BE REPRODUCED, IN PART OR IN FULL, WITHOUT SPECIFIC APPROVAL OF THE DIVISION OF LAND INFORMATION SYSTEMS, LEE COUNTY, FLORIDA. LEE COUNTY COURTHOUSE 2115 SECOND STREET FT. MYERS, FLORIDA

COPYRIGHT BY LEE COUNTY, FLORIDA. ALL RIGHTS RESERVED.

GRIDS BASED ON THE FLORIDA STATE PLANE COORDINATE SYSTEM, WEST ZONE.

ELEVATIONS BASED ON U.S.C. & G.S. DATUM.

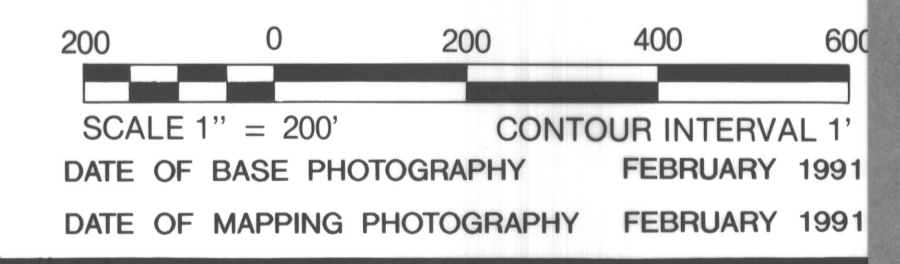

LEE COUNTY FT. MYERS, FLORIDA

**LAND INFORMATION SYSTEMS**

SECTION 6 TOWNSHIP 44 SOUTH RANGE 27 EAST

DRAWING NUMBER SHEET OF

6-44-27