



COMPILED BY PHOTOGRAMMETRIC METHODS BY

WOOLPERT CONSULTANTS
 DAYTON & CINCINNATI OHIO · CHARLOTTE NORTH CAROLINA
 MOBILE ALABAMA · ORLANDO & PENSACOLA FLORIDA

GEODETIC CONTROL SURVEY BY

Deni Associates
 FT. MYERS, FLORIDA

LEGEND

- HORIZONTAL CONTROL U.S.C. & G.S. △
- FLORIDA STATE DEPT. OF TRANSPORTATION ○
- TRAVERSE STATIONS ○
- SECTION CORNERS X
- VERTICAL CORNERS X
- CONTOURS —
- DEPRESSION CONTOURS - - -
- SPOT ELEVATIONS X
- STATE ROUTE —
- U.S. ROUTE —
- INTERSTATE HIGHWAY —
- POLITICAL BOUNDARIES - - -

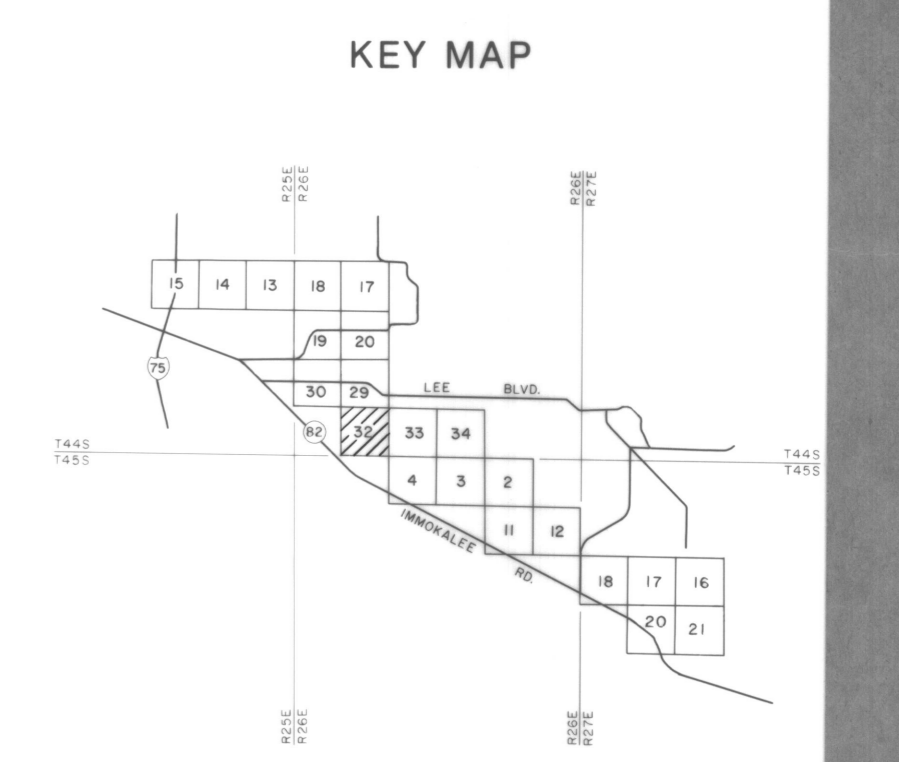
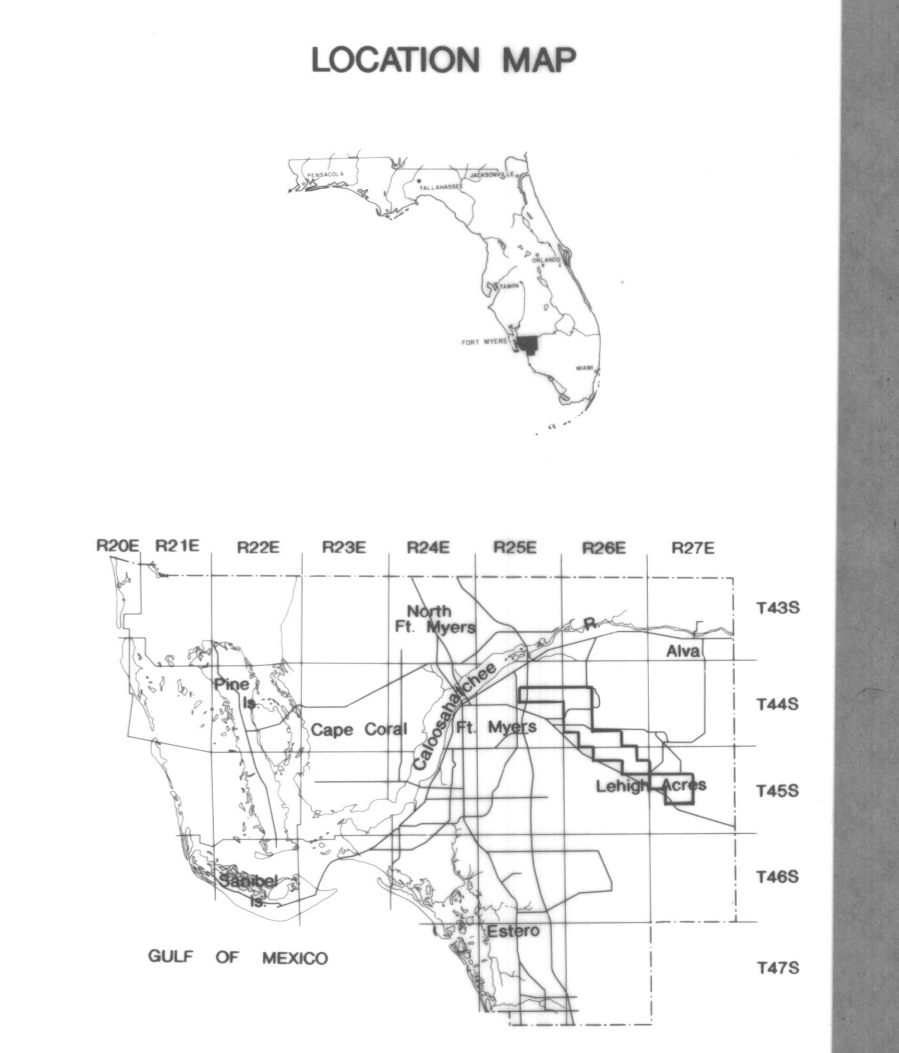

NOTE:

ACCURACY: THIS MAPPING IS INTENDED TO COMPLY WITH NATIONAL MAP ACCURACY STANDARDS. HOWEVER, SUCH ACCURACY, OR ANY OTHER LEVEL OF ACCURACY, IS NOT GUARANTEED BY LEE COUNTY, FLORIDA.

THE LAND LINE INFORMATION SHOWN IS COMPILED FROM THE BEST AVAILABLE DATA AND DOES NOT NECESSARILY REPRESENT TRUE LAND LINE LOCATION.

DASHED CONTOURS AND UNDERLINED ELEVATIONS INDICATE STANDARD VERTICAL ACCURACY REDUCED BY TREE COVER.

THIS SHEET MAY NOT BE REPRODUCED, IN PART OR IN FULL, WITHOUT SPECIFIC APPROVAL OF THE DIVISION OF LAND INFORMATION SYSTEMS, LEE COUNTY, LEE COUNTY COURTHOUSE, 215 SECOND STREET, FT. MYERS, FLORIDA.

COPYRIGHT BY LEE COUNTY, FLORIDA. ALL RIGHTS RESERVED.

GRIDS BASED ON THE FLORIDA STATE PLANE COORDINATE SYSTEM, WEST ZONE.

ELEVATIONS BASED ON U.S.C. & G.S. DATUM.

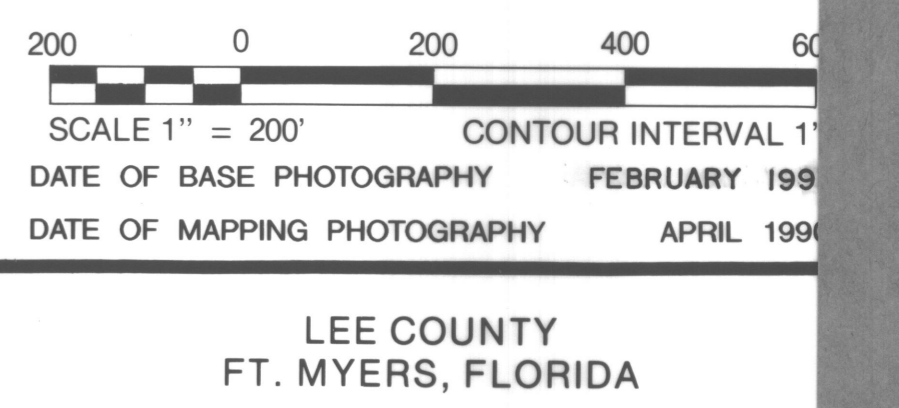

LEE COUNTY
 FT. MYERS, FLORIDA

LAND INFORMATION SYSTEMS

SECTION 32 TOWNSHIP 44 SOUTH RANGE 26 E

DRAWING NUMBER SHEET OF

32-44-26