

E 730,000 E 731,000 E 732,000 E 733,000 E 734,000 E 735,000

N 854,000 N 853,000 N 852,000 N 851,000



COMPILED BY PHOTOGRAMMETRIC METHODS BY GEODETIC CONTROL SURVEY BY



LEGEND

- HORIZONTAL CONTROL U.S.C. & G.S.
- FLORIDA STATE DEPT. OF TRANSPORTATION
- TRAVERSE STATIONS
- VERTICAL CONTROLS
- SECTION CORNERS
- CONTOURS
- DEPRESSION CONTOURS
- SPOT ELEVATIONS
- STATE ROUTE
- U.S. ROUTE
- INTERSTATE HIGHWAY
- POLITICAL BOUNDARIES

KEY MAP

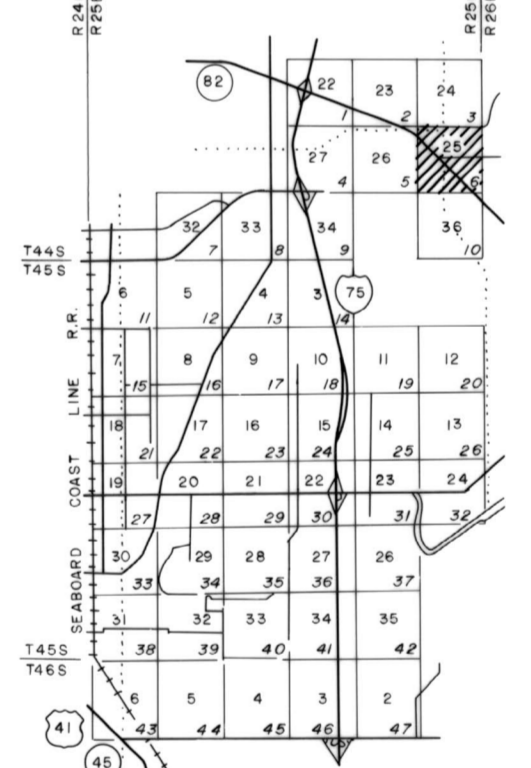

GRID NUMBERS REPRESENT SECTION NUMBERS
BLANKED NUMBERS REPRESENT SHEET NUMBERS

NOTE:

ACCURACY: THIS MAPPING IS INTENDED TO COMPLY WITH NATIONAL MAP ACCURACY STANDARDS. HOWEVER, SUCH ACCURACY, OR ANY OTHER LEVEL OF ACCURACY, IS NOT GUARANTEED BY LEE COUNTY, FLORIDA.

THE LAND LINE INFORMATION SHOWN IS COMPILED FROM THE BEST AVAILABLE DATA AND DOES NOT NECESSARILY REPRESENT TRUE LAND LINE LOCATION.

CONTOUR LINES ARE DIGITALLY COMPILED BY PHOTOGRAMMETRIC METHODS TO NATIONAL MAP ACCURACY STANDARDS. HOWEVER, THEY DO NOT NECESSARILY FIT THE HORIZONTAL POSITION OF THE PHOTOGRAMMETRIC BASE DUE TO RELIEF DISPLACEMENT.

DASHED CONTOURS AND UNDERLINED ELEVATIONS INDICATE STANDARD VERTICAL ACCURACY REDUCED BY TREE COVER.

THIS SHEET MAY NOT BE REPRODUCED, IN PART OR IN FULL, WITHOUT SPECIFIC APPROVAL OF THE DIVISION OF LAND INFORMATION SYSTEMS, LEE COUNTY.

L.S. DIV.
1609 HEITMAN ST.
FT. MYERS, FLORIDA

COPYRIGHTED BY LEE COUNTY, FLORIDA.
ALL RIGHTS RESERVED.

GRIDS BASED ON THE FLORIDA STATE PLANE COORDINATE SYSTEM, NAD, 1983

ELEVATIONS BASED ON U.S.C. & G.S. DATUM

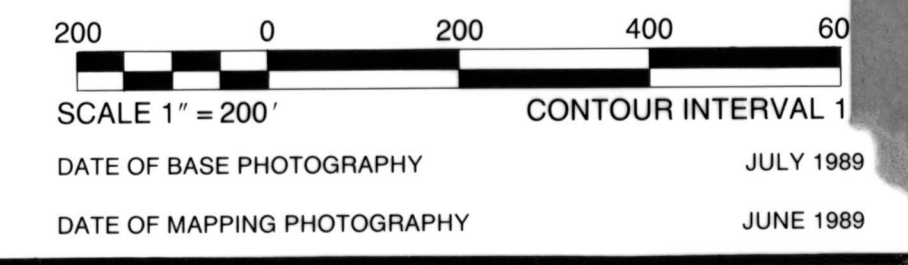

DATE OF BASE PHOTOGRAPHY JULY 1989
DATE OF MAPPING PHOTOGRAPHY JUNE 1989

LEE COUNTY
FT. MYERS, FLORIDA

SIX MILE CYPRESS / TEN MILE BASIN
LAND INFORMATION SYSTEMS

SECTION 25 TOWNSHIP 44 SOUTH RANGE 25 EAST
DRAWING NUMBER SHEET 6 OF 47

445
25E
-25-
1989

25-44-25