



COMPILED BY PHOTOGRAMMETRIC METHODS
BY



HAMRICK
Aerial Surveys, Inc.

2028 PALMETTO STREET CLEARWATER, FLORIDA 33575

LEGEND

HORIZONTAL CONTROL U.S.C.&G.S.	△
TRAVERSE STATIONS	4-5-2 ○
VERTICAL CONTROLS	9.13 X
SECTION CORNERS	2 1 11 12
CONTOURS	5 10 15
DEPRESSION CONTOURS	10 15
SPOT ELEVATIONS	12.5
T. B. M.	TBM X 7.2

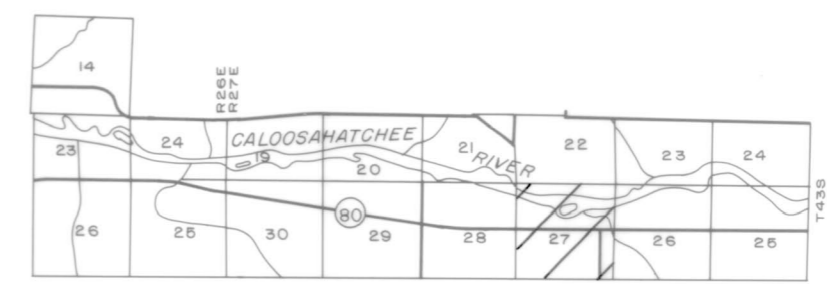
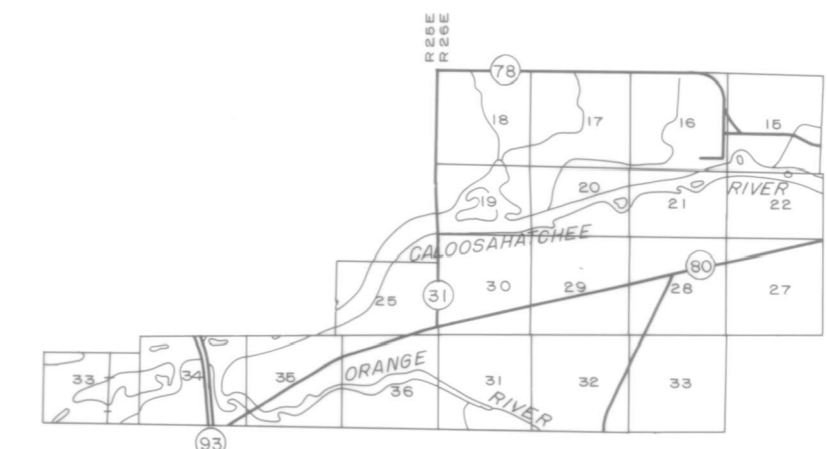

GEODETIC CONTROL SURVEYS
BY
 FLORIDA DEPARTMENT OF TRANSPORTATION

NOTE ACCURACY - IT IS INTENDED THAT THIS MAPPING COMPLY WITH U.S. NATIONAL MAP ACCURACY STANDARDS. HOWEVER, SUCH ACCURACY OR ANY OTHER LEVEL OF ACCURACY IS NOT GUARANTEED BY LEE COUNTY, FLORIDA.

THE LAND LINE INFORMATION SHOWN HERE ON IS COMPILED FROM THE BEST AVAILABLE DATA AND DOES NOT NECESSARILY REPRESENT TRUE LAND LINE LOCATION.

DASHED CONTOURS AND UNDERLINED ELEVATIONS INDICATE STANDARD VERTICAL ACCURACY REDUCED BY HEAVY FOLIAGE COVER.

GRIDS BASED ON FLORIDA STATE PLANE COORDINATE SYSTEM WEST ZONE.

ELEVATIONS BASED ON USC & GS DATUM.



SCALE 1" = 300' CONTOUR INTERVAL 1'
DATE OF PHOTOGRAPHY MARCH 85
DATE OF MAPPING MARCH 85

LEE COUNTY
FLORIDA

SECTION 27 T 43 S R 27 E

43S
27E
-27-
1985

27-43-27