

COMPILED BY PHOTOGRAMMETRIC METHODS BY

WOOLPERT CONSULTANTS

DAYTON & CINCINNATI, OHIO CHARLOTTE, NORTH CAROLINA
MOBILE, ALABAMA ORLANDO & PENSACOLA, FLORIDA

GEODETIC CONTROL SURVEY BY

Dani Associates
FT. MYERS, FLORIDA

LEGEND

HORIZONTAL CONTROL U.S.C.&G.S.

FLORIDA STATE DEPT. OF TRANSPORTATION

TRAVERSE STATIONS

VERTICAL CONTROLS

SECTION CORNERS

CONTOURS

DEPRESSION CONTOURS

SPOT ELEVATIONS

STATE ROUTE

U.S. ROUTE

INTERSTATE HIGHWAY

POLITICAL BOUNDARIES

LOCATION MAP

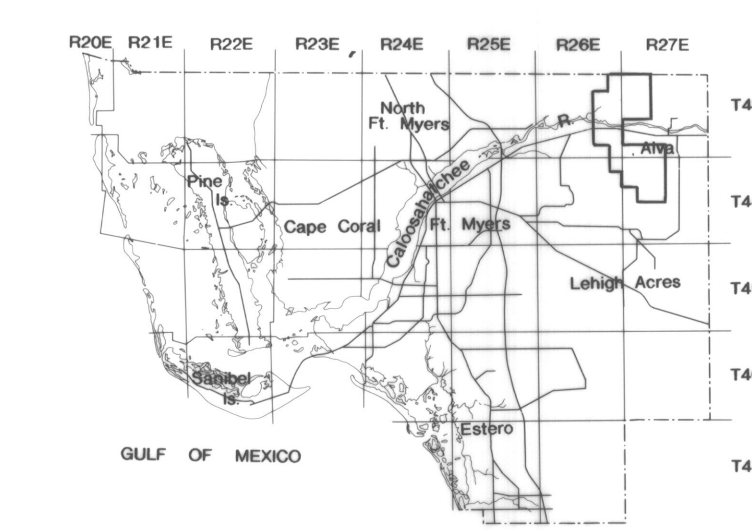
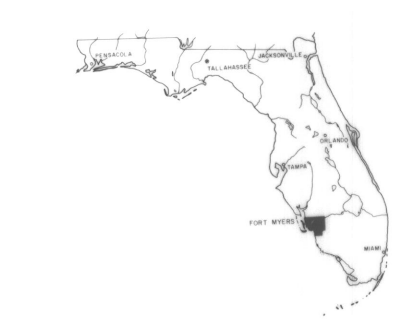

KEY MAP

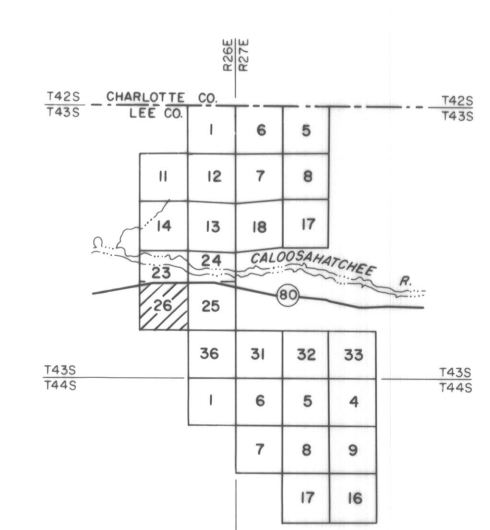

NOTE:

ACCURACY: THIS MAPPING IS INTENDED TO COMPLY WITH NATIONAL MAP ACCURACY STANDARDS. HOWEVER, SUCH ACCURACY OR ANY OTHER LEVEL OF ACCURACY IS NOT GUARANTEED BY LEE COUNTY, FLORIDA.

THE LAND LINE INFORMATION SHOWN IS COMPILED FROM THE BEST AVAILABLE DATA AND DOES NOT NECESSARILY REPRESENT TRUE LAND LINE LOCATION.

DASHED CONTOURS AND UNDERLINED ELEVATIONS INDICATE STANDARD VERTICAL ACCURACY REDUCED BY TREE COVER.

THIS SHEET MAY NOT BE REPRODUCED, IN PART OR IN FULL, WITHOUT SPECIFIC APPROVAL OF THE DIVISION OF LAND INFORMATION SYSTEMS, LEE COUNTY, FLORIDA.

LEE COUNTY COURTHOUSE
215 SECOND STREET
FT. MYERS, FLORIDA

COPYRIGHT BY LEE COUNTY, FLORIDA.
ALL RIGHTS RESERVED.

GRIDS BASED ON THE FLORIDA STATE PLANE COORDINATE SYSTEM, WEST ZONE.

ELEVATIONS BASED ON U.S.C.&G.S. DATUM.

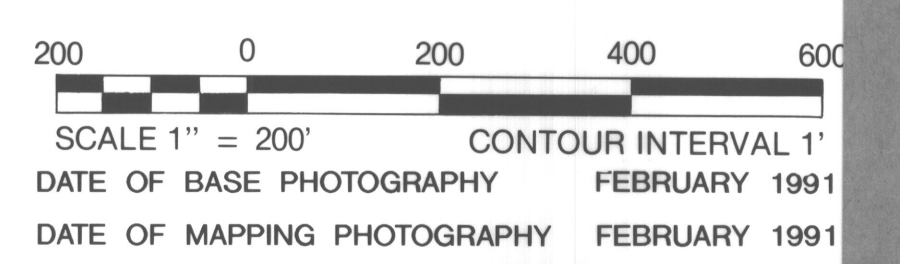

LEE COUNTY
FT. MYERS, FLORIDA

LAND INFORMATION SYSTEMS

SECTION 26 TOWNSHIP 43 SOUTH RANGE 26 EA

DRAWING NUMBER SHEET OF

26-43-26